

2500 Series



Hager 2500 Series Grade 2 lock is a perfect combination of value and performance and is the ideal choice of lock for typical commercial applications. The inherent value of this lock and the product offering make our 2500 Series lock a perfect choice for a stocking program. As an economical alternative to other Grade 2 cylindrical locks, it offers both dependability and affordability.





2500 SERIES - HOW TO ORDER

2553	2- ³ / ₄ "	US3	US26D	ARC	SCC	KD	ASA	TW
Function 10 - Passage 17 - Single Dummy 25 - Exit 27 - Double Dummy 40 - Privacy 50 - Entry/Office 53 - Entry 70 - Classroom 80 - Storeroom		Finish US3 US10B US26D		Interior Finish (If Different)	Conventional Keyway SCC - Schlage C AR1 - Arrow C60 - Corbin 60 C67 - Corbin 67 C77 - Corbin 77 CL4 - Corbin L4 H1 - Hager 1 H2 - Hager 2 H3 - Hager 3 SCE - Schlage E SCF - Schlage F KW1 - Kwikset RD1 - Russwin D1 SGT - Sargent LA YAP - Yale E1R (Para) YGA - Yale GA WE - Weiser E NC - No cylinder (SFIC Housing Only)		Strike ASA (Standard) Full Lip RC Full Lip TEE	Options TW - Tactile Warning LL - Leadlined 6PKEY - 6-pin Keyed 7PKEY - 7-pin Keyed (Hager) SFIC* - Small Format Interchangeable Core Prep
Backset/Faceplate 2-3/4" (70 mm), SC (Standard) 2-3/4" (70 mm), RC 2-3/8" (60 mm), SC 2-3/8" (60 mm), RC					Keying KA - Keyed Alike KD - Keyed Different MK - Master Key CMK - Construction Master Key SK - Customer Specified Keying 0BC - "0" Bitted Cylinder (Conventional Only) 1BC - "1" Bitted Cylinder (Conventional Only)			
Product Group 25 - Cylindrical, Grade 2				Lever Style ARC - Archer Lever WTN - Withnell Lever				

Notes:

1. If masterkeyed, include completed master key form with order (available on page 88 or www.hagerco.com).
2. For additional keying information, please refer to cylinder, core, and keying section of catalog (page 73).









* Small format interchangeable core sold separately. Available in Best Keyways (A Standard), or Hager Keyways (optional).

Ordering example: 2553 2-3/4" US26D WTN NC ASA SFIC





2500 SERIES - FUNCTION CHART

	Function	Function No.	Function Description	ANSI No.
Non-Keyed				
	Passage	10	Latchbolt operated by lever from either side at all times.	F75
	Dummy - Single	17	Pull one side, no mechanical operation.	-
	Exit	25	Blank plate outside (13/16" [31 mm] projection). Inside lever is always unlocked.	F111
	Dummy - Double	27	Pull both sides. No mechanical operation (back to back).	-
	Privacy	40	Latchbolt operated by lever from either side. Outside lever is locked by push button inside and unlocked by emergency release outside, operating inside lever or closing door.	F76A
Keyed				
	Entry/Office	50	Deadlocking latchbolt operated by lever from either side except when outside lever is locked by push button on inside lever. When outside lever is locked, operating key in outside lever or operating inside lever unlocks push button or other locking device and retracts latchbolt. Closing door does not release push button.	F82A
	Entry	53	Deadlocking latchbolt by lever either side, except when turn button inside locks outside lever. Pushing turn button in locks outside lever, requiring use of key outside to unlock. Turning inside lever unlocks outside lever. Pushing in and turning button locks outside lever, requiring key at all times. Turning inside lever does not unlock outside lever until button is manually turned to unlocked position. Inside lever always free.	F109
	Classroom	70	Deadlocking latchbolt operated by lever from either side except when outside lever is locked from outside by key. When outside lever is locked, latchbolt is operated by inside lever.	F84
	Storeroom	80	Deadlocking latchbolt operated by key in outside lever, or by operating inside lever. Outside lever is always locked. Inside lever is always unlocked.	F86



2500 SERIES - LEVER OPTIONS

ARCHER LEVER

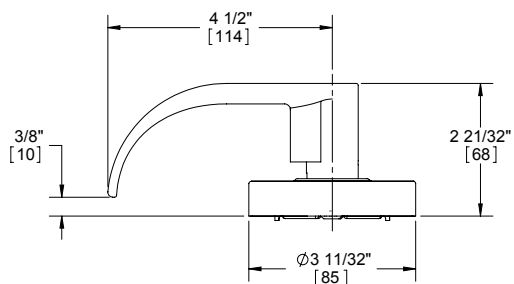

WITHNELL LEVER

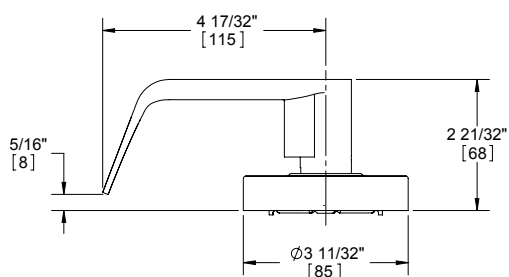

Optional tactile warning available on all lever styles (only outside lever will include raised surfaces unless otherwise specified).





2500 SERIES - GRADE 2 CYLINDRICAL - STANDARD DUTY COMMERCIAL

WARRANTY | Five year warranty

FEATURES

- No exposed mounting screws
- Non-handed
- Conventional cylinder and small format interchangeable core option available

Applications:

- Standard duty commercial
- Standard door prep - 2-1/8" (54 mm) diameter (bore)
- Latch hole - 1" (25.4 mm) diameter (cross bore)

Certifications:

- Meets BHMA ANSI A156.2, Series 4000, Grade 2
- ADA Compliant ANSI A117.1 Accessibility Code
- UL/cUL Listed for all functions up to 3 hours "A" label single doors
- UL 10C Positive Pressure Related
- UL 10B Neutral Pressure Rated

Lever Options: Archer, Withnell levers

Options:

- Lead lined
- Tactile warning

SPECIFICATIONS

Exposed Trim:

- Wrought brass, bronze, and stainless steel
- Lever is zinc based, plated to match BHMA symbols

Rose Diameter: 3-11/32" (85 mm)

Lock Chassis:

- Heavy gauge steel, zinc dichromated for corrosion resistance
- "Non-clutching" exterior lever on keyed functions
- Removable thru-bolts
- Failure to install thru-bolts and removable screw posts voids BHMA certification, UL rating, and warranty

Keys: Two operating keys supplied per lock

Cylinders/Cores:

- Brass, keyed different, Schlage C keyway standard
- Cylinder drilled 6-pin, keyed 5-pin
- Other keying options, including keyed 6-pin, available from the factory (see cylinders, cores and keying sections).
- Zero bit cylinders will be 6 pin keyed – standard
- Small Format Interchangeable Core option available
- SFIC uncombined or combined, brass 6- or 7-pin cores sold separately

Door Thickness: 1-3/8" - 2" (35 mm - 51 mm)

Backset:

- 2-3/4" (70 mm) - Standard
- 2-3/8" (60 mm) - Optional

Latchbolt:

- 1/2" (13 mm) throw, stainless steel
- 1-1/8" x 2-1/4" (29 mm x 57 mm) faceplate for 2-3/4" (70 mm) backset
- 1" x 2-1/4" (25 mm x 57 mm) faceplate for 2-3/8" (60 mm) backset
- Deadlocking latchbolt prevents manipulation when door is closed; keyed functions and 25 function only

Strike:

- 3935 ASA 1-1/4" x 4-7/8" (32 mm x 124 mm) strike standard
- Optional strikes available

Functions: 10 Passage, 17 Dummy, 25 Exit Only, 27 Back to Back Dummy, 40 Privacy, 50 Entry/Office, 53 Entry, 70 Classroom, 80 Storeroom

Notes: Blank plate projection is 13/16" (21 mm) for function 25

FINISHES | US3, US10B, US26D





2500 SERIES - LATCHBOLTS

Spring Latches



3947

**2-3/4" (70 mm) Backset
Passage Spring Latch**

- Square and round corner available
- 1-1/8" x 2-1/4" (29 mm x 57 mm) faceplate

3949

**2-3/8" (60 mm) Backset
Passage Spring Latch**

- Square and round corner available
- 1" x 2-1/4" (25 mm x 57 mm) faceplate



3965

**2-3/4" (70 mm) Backset
Privacy Spring Latch**

- Square and round corner available
- 1-1/8" x 2-1/4" (29 mm x 57 mm) faceplate

3967

**2-3/8" (60 mm) Backset
Privacy Spring Latch**

- Square and round corner available
- 1" x 2-1/4" (25 mm x 57 mm) faceplate

Dead Latches



3948

**2-3/4" (70 mm) Backset
Dead Latch**

- Square and round corner available
- 1-1/8" x 2-1/4" (29 mm x 57 mm) faceplate

3950

**2-3/8" (60 mm) Backset
Dead Latch**

- Square and round corner available
- 1" x 2-1/4" (25 mm x 57 mm) faceplate

Optional Drive-In Spring Latches



3922

**2-3/4" (70 mm) Backset
Passage Spring Latch**

3925

**2-3/8" (60 mm) Backset
Passage Spring Latch**



3923

**2-3/4" (70 mm) Backset
Privacy Spring Latch**

3926

**2-3/8" (60 mm) Backset
Privacy Spring Latch**

Optional Drive-In Dead Latches



3924

**2-3/4" (70 mm) Backset
Dead Latch**

3927

**2-3/8" (60 mm) Backset
Dead Latch**

Backset Extension Links



3917

**3-3/4" (95 mm) Backset
Extension Link**

For use with 2-3/8" (60 mm) backset latch to achieve 3-3/4" total backset



3937

**5" (127 mm) Backset
Extension Link**

For use with 2-3/4" (70 mm) backset latch to achieve 5" total backset





2500 SERIES - STRIKES

2500 SERIES ACCESSORIES



3933
T-Strike with Plastic Dust Box
 1-1/8" x 2-3/4" (29 mm x 70 mm)



3911
Thru-Bolt Jig



3934
Full Lip Strike
 1-5/8" x 2-1/4" (41 mm x 57 mm)



3935
ASA Strike Plate - Standard
 • 1-1/4" x 4-7/8" (32 mm x 124 mm)
 • 1-5/16" lip
 • Other lengths available upon request



3958
Full Lip Strike with Round Corner
 • 1-5/8" x 2-1/4" (41 mm x 57 mm)
 • 1/4" (6 mm) radius



3959
Faceplate Adapter
 Converts 1" (25 mm) to 1-1/8" (28 mm) width