

# I-QWIK LITE ELECTRONIC ACCESS CONTROL

## NO-NONSENSE ACCESS CONTROL RIGHT OUT OF THE BOX!



IQ1LITE Cylindrical Model Shown;  
19 Black Powder Coat finish with  
26D Satin Chrome Plated American Levers

### iQwik INSTALLATION

### iQwik PROGRAMMING

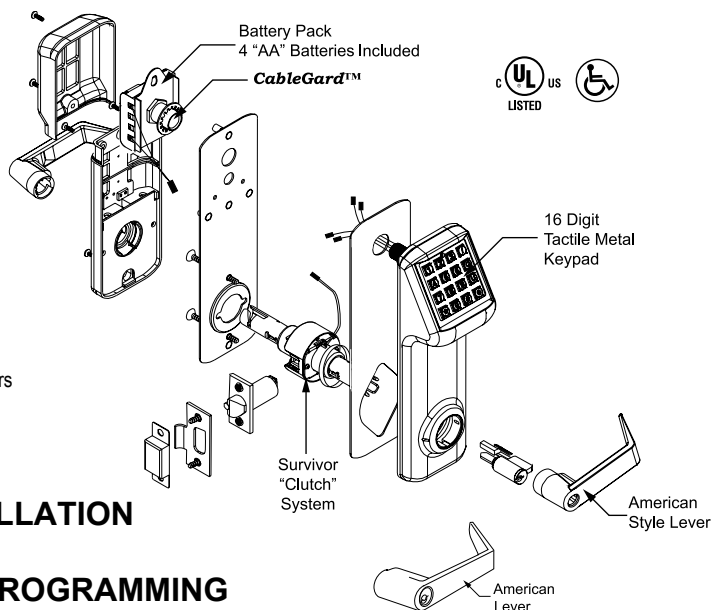

MARKS #		LOCKSET TYPE	# OF USERS	FINISH GROUPS	
For Finish 19	For Finish 26D				
IQ1LITE	IQ1L/26D	Cylindrical Lockset	160	19: Black Powder Coat with 26D Satin Chrome Plated American Levers	26D: Satin Chrome Plated
IQ2LITE	IQ2L/26D	Mortise Lockset			
IQ7LITE	IQ7L/26D	Rim Exit Device Interface <i>Adapter plates operate most manufacturers Rim Exit Devices</i> <i>Adapter plates for Mounting Exit Devices are sold separately, see page 21.</i>			

#### I-QWIK LITE STANDARD FEATURES

- **CableGard™** protects wires for easy installation
- Standard ANSI door prep with one additional hole
- Pre-programmed code
- Keypad programmable
- 160 User codes
- Temporary user codes
- Passage mode
- Pin only mode
- Double code entry for maximum security
- Two wire remote release
- 16 Digit tactile metal keypad
- Weatherproof standard
- Audible & visible entry indicator
- Audible low battery alert
- 4 "AA" batteries, 95,000 operations
- Easy installation

#### LOCKSET SPECIFICATIONS

##### IQ1 LITE CYLINDRICAL LOCKSET

Door Thickness: 1-3/4" standard  
*For thicker doors, Consult factory*

Handing: Non-handed

Key Override: Marks "C" keyway, 6 pin w/2 keys, IC Core optional

Lock Body: Cylindrical "Survivor" featuring the "Clutch" for trouble free service

Latch: Grade 2, 2-3/4" backset, 1/2" throw, 3 Hour UL fire rated

Strike Plate: 4-7/8" ASA strike

##### IQ2 LITE MORTISE LOCKSET

Door Thickness: 1-3/4" standard  
*For thicker doors, Consult factory*

Handing: Field reversible

Key Override: 1-1/8" Mortise cylinder, 6 pin w/2 keys

Lock Body: Grade 1, Series 5, 2-3/4" backset, 3/4" anti-friction latch, 3 Hour UL fire rating

Auxiliary Latch: 1/2" throw

Bolt Throw: 1" (Optional deadbolt functions - Consult factory)

Clutch: The "Clutch" for trouble free service

Strike Plate: 4-7/8" ASA standard

##### IQ7 LITE RIM EXIT DEVICE INTERFACE

Door Thickness: 1-3/4" standard  
*For thicker doors, Consult factory*

Handing: Non-handed

Key Override: 1-1/8" Mortise cylinder, 6 pin w/2 keys

Clutch: The "Clutch" for trouble free service

**Adapter plates operate most manufacturers Rim Exit Devices.**  
**Adapter plates for Mounting Exit Devices are sold separately, see page 21.**

**LIFETIME MECHANICAL WARRANTY; 2 YEAR ELECTRONIC WARRANTY**

# I-QWIK SERIES ELECTRONIC ACCESS CONTROL

## RIM EXIT DEVICE STAND ALONE ACCESS CONTROL



IQ7DATA/26D Rim Exit Device  
Interface Model Shown

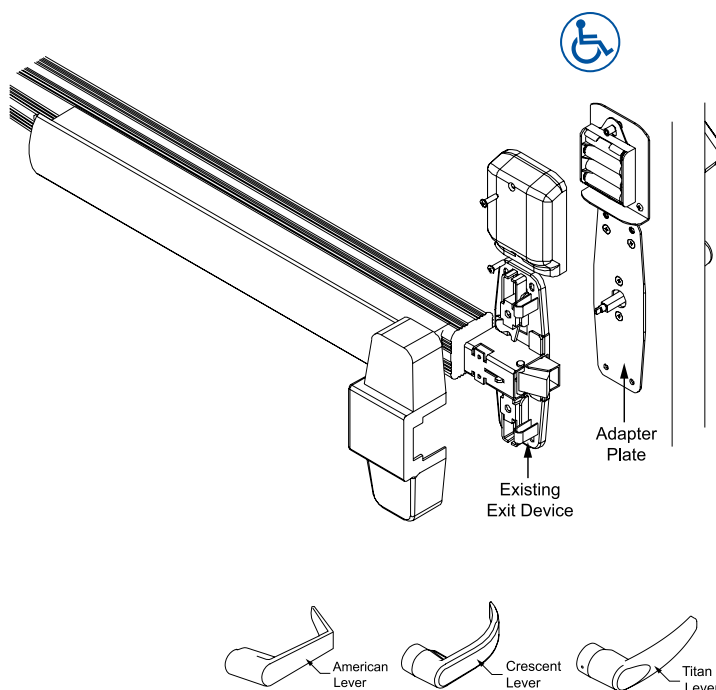

MARKS #		LOCKSET TYPE	FINISH GROUPS	
For Finish 19	For Finish 26D			
IQ7LITE	IQ7L/26D	Rim Exit Device Interface <i>Adapter plates operate most manufacturers Rim Exit Devices Adapter plates for Mounting Exit Devices are sold separately, see below.</i>	<b>19:</b> Black Powder Coat with 26D Satin Chrome Plated American Levers	<b>26D:</b> Satin Chrome Plated

### STANDARD FEATURES

- For the IQ7 LITE standard features and lockset specifications, see page 18.
- Additional finishes, consult factory

### ADAPTER PLATES

Rim exit device interface with a choice of adapter plates to fit most rim exit devices (*available separately*) are listed below:

DESCRIPTION	PART #
M9900 - Von Duprin 99 Rim Adapter Plate/Detex Advantex 10 Series Rim Adapter Plate	E7071
Precision 1100 Rim Adapter Plate	E7072
Yale 7100 Rim Adapter Plate/Corbin ED5200 Rim Adapter Plate	E7073
Dorma 9300 Rim Adapter Plate	E7074
Sargent 8800 Rim Adapter Plate/Arrow 3800 Rim Adapter Plate	E7075
<b>Precision 21 Rim Adapter Plate/Precision 2100 Rim Adapter Plate**</b>	E7076
Von Duprin 88 - <b>Special Order, Consult Factory</b>	E7077
Monarch 18R Exit Device Adapter Plate	E7078

**\*\* MUST USE PRECISION #BP21 BACKPLATE**

**LIFETIME MECHANICAL WARRANTY; 2 YEAR ELECTRONIC WARRANTY**