

NFPA 80, Section 3-3.8 requires intermediate pivot on some fire door applications, consult product support. Use for door heights over 7'0" and one every 2'6" as needed.

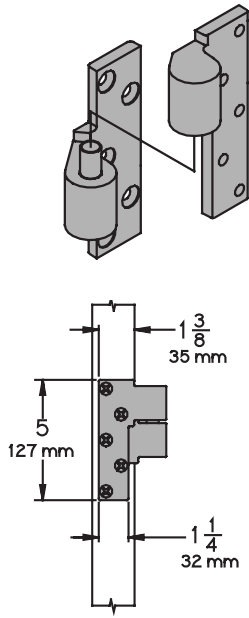

7230F-7237F INT 3/4" Offset intermediate pivot, fire rated

- This intermediate pivot is used with 7230F and 7237F offset pivots
- Use for door weight over the pivot set limit. Use one additional pivot for every additional 100 pounds.
- Recommended for use with 1-3/4" minimum door thickness, with 1/8" bevel in 2"
- Handed LH or RH

Certifications

- Meets ANSI/BHMA A156.4 C07311
- UL Listed, 3 hour fire doors

Material substrate

- Made from 304 series stainless steel

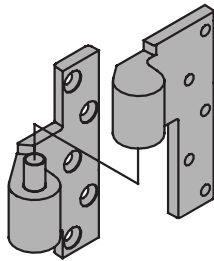
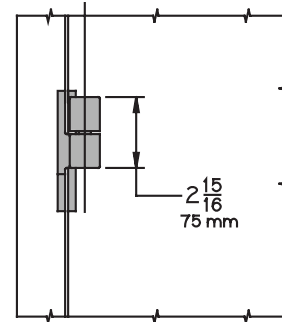
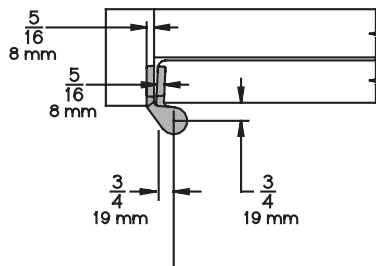

7244F-7245F INT 1 1/2" Offset intermediate pivot, fire rated

- This intermediate pivot is used with 7244F and 7245F offset pivots
- Use for door weight over the pivot set limit. Use one additional pivot for every additional 100 pounds.
- Recommended for use with 1-3/4" minimum door thickness, with 1/8" bevel in 2"
- Handed LH or RH

Certifications

- Meets ANSI/BHMA A156.4 C07371
- UL Listed, 3 hour fire doors

Material substrate

- Made from 304 series stainless steel

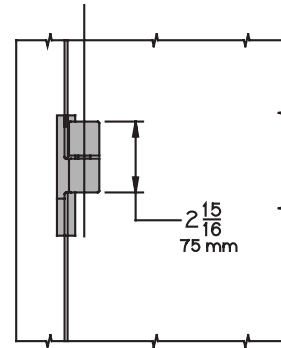
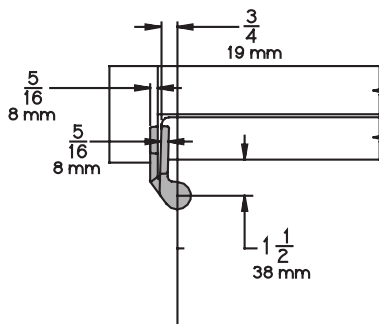

7230F-7237F INT and 7244F-7245F INT Finishes

BHMA	Description	Substrate	Finish
629	Bright stainless	Stainless steel	US32
630	Satin stainless	Stainless steel	US32D
631	Matte black	Stainless steel	BLK
632	Bright brass	Stainless steel	US3
639	Satin bronze	Stainless steel	US10
---	Aged bronze	Stainless steel	643e/716
689	Aluminum painted	Stainless steel	SP28
691	Bronze painted	Stainless steel	SP10
695	Dark bronze painted	Stainless steel	SP313
706	Brass painted	Stainless steel	SP4

For other colors, consult factory.