

INSTALLATION INSTRUCTIONS

Effective date: March 1, 2025

Supercedes: All Previous

McKinney®

ASSA ABLOY

Experience a safer
and more open world

NOT TO SCALE

4007 GATE SPRING PIVOT HINGE

Parts

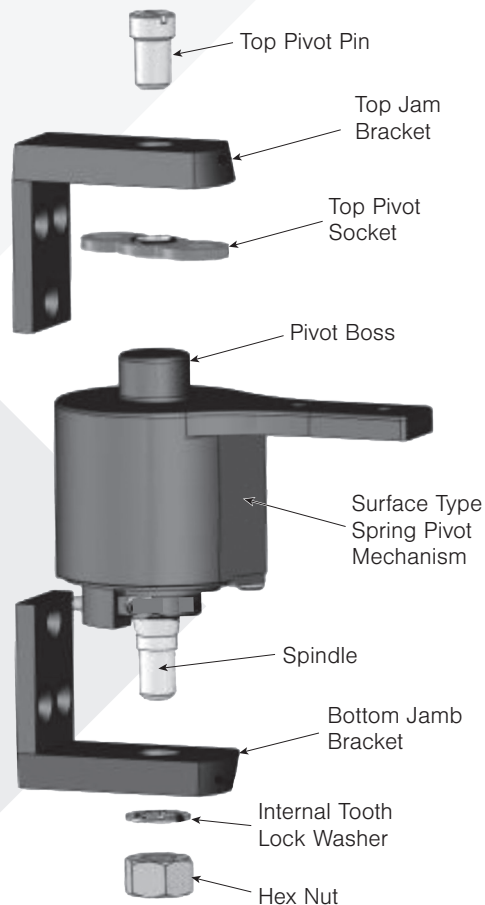

2. Door Preparation

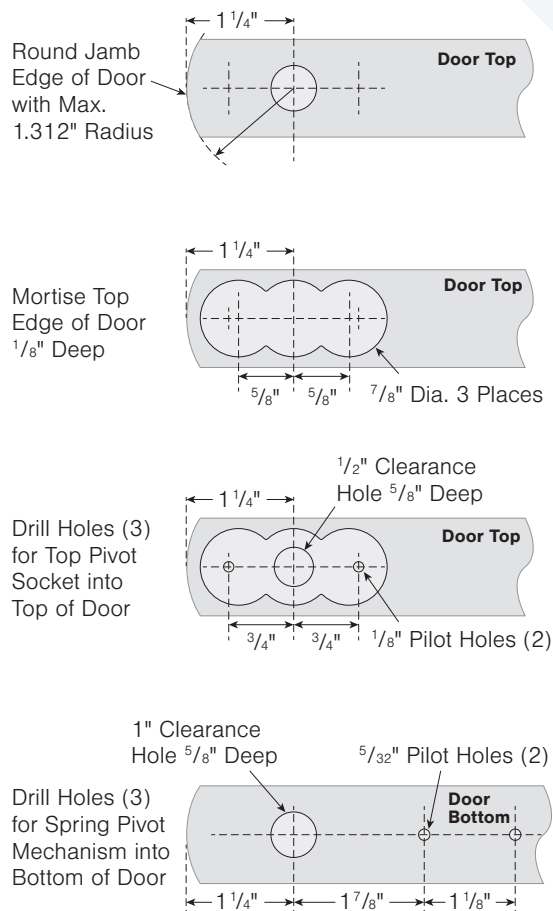

Installation Instructions:

1. Install Top Jamb Bracket

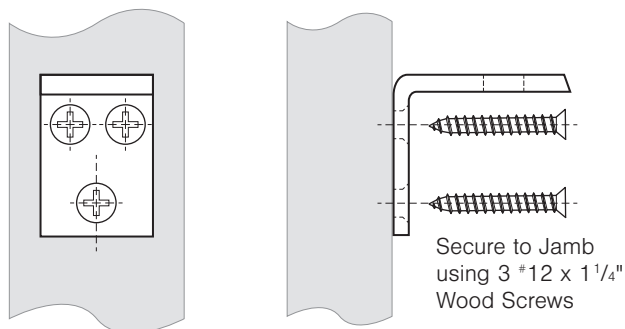

3. Fasten Top Pivot Socket

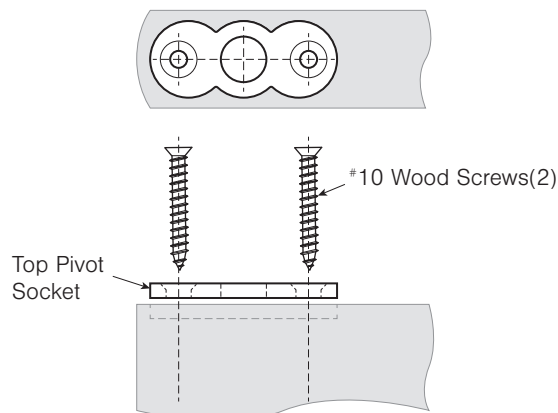

NOT TO SCALE

4. Fasten Spring Pivot Mechanism to Bottom of Door

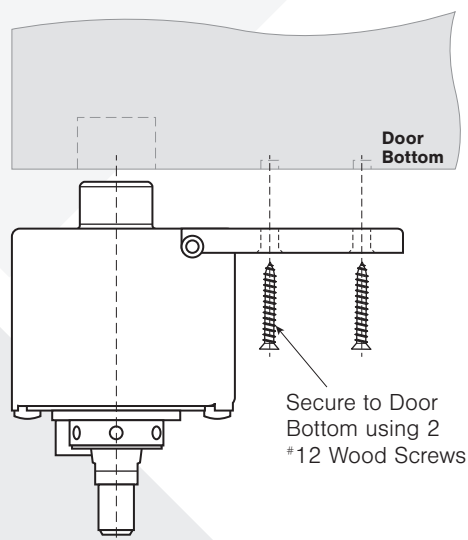

5. Install Bottom Jamb Bracket

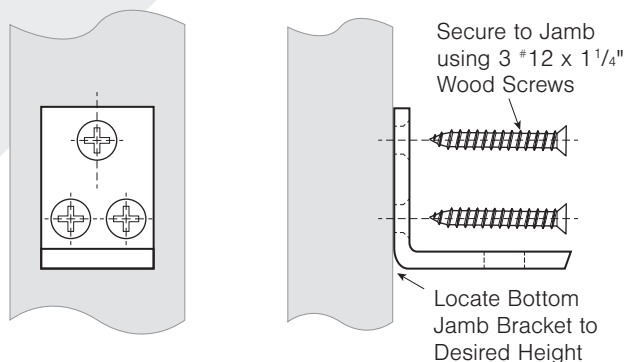

6. Install Door

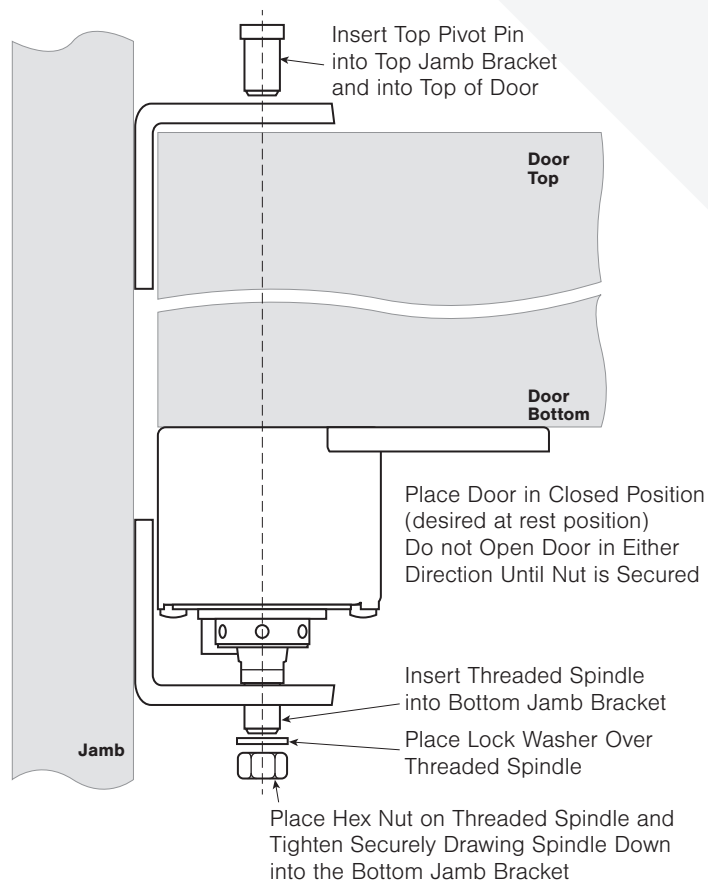

Swing Arc

