

Installation Instructions

SARGENT
ASSA ABLOY

P700 NE & P700 WE Series

Lever Handle with Exit Trim Spindle Interaction

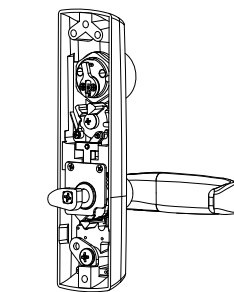
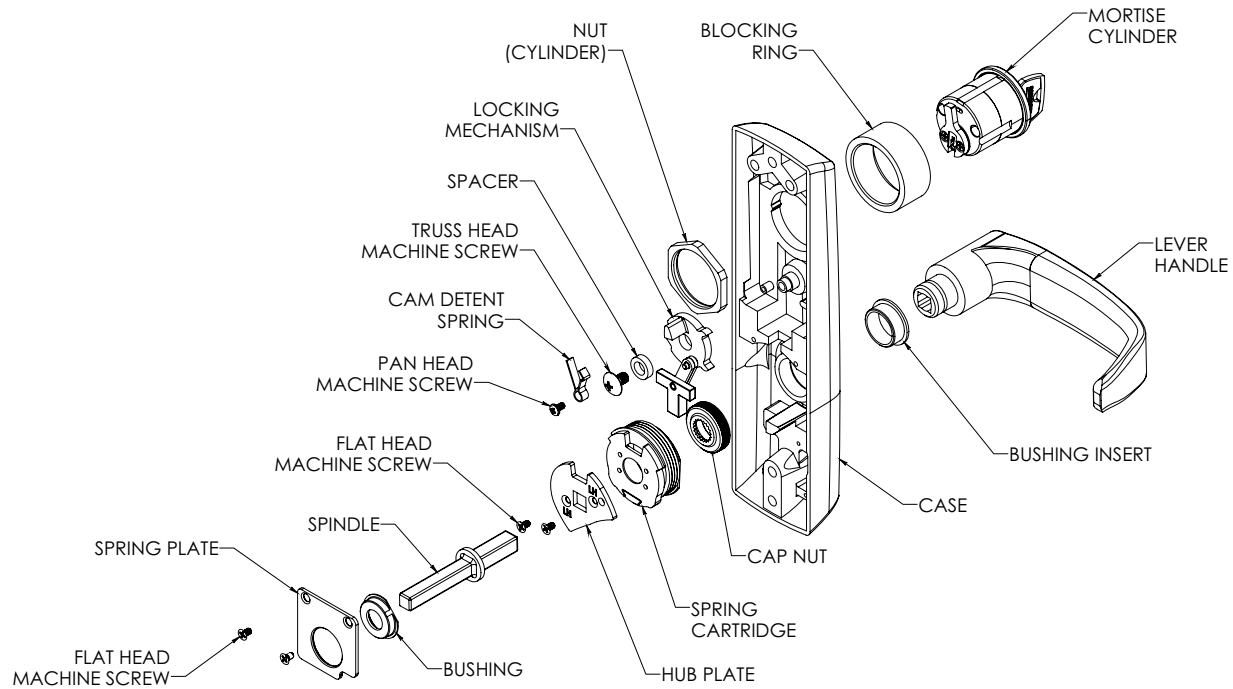

P700-4 NE Trim
shown

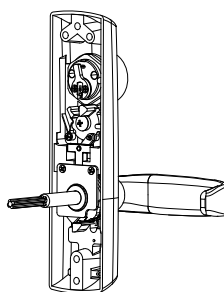

P700-8 NE Trim
shown

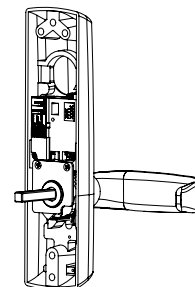

P700 NE Ecoflex
Electrical Trim shown

WARNING

This product can expose you to lead which is known to the state of California to cause cancer and birth defects or other reproductive harm. For more information go to www.P65warnings.ca.gov.

WARNING

Attention Installer: Improper installation may result in damage to the product and void the factory warranty.

1-800-727-5477 • www.sargentlock.com

Copyright © 2023, SARGENT Manufacturing Company. All rights reserved. Reproduction in whole or in part without the express written permission of SARGENT Manufacturing Company is prohibited. Patent pending and/or patent www.assaabloydss.com/patents.

A8312-1 5/23

Experience a safer
and more open world

P700 NE & P700 WE Series

Lever Handle with Exit Trim

Installation Instructions

SARGENT®

ASSA ABLOY

P700 series control used with PE8700 and NB PE8700 surface mounted vertical rod exit devices.

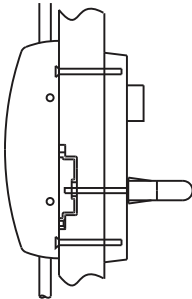

PE8700 RHRB shown

P700 series control used with PE8816 rim exit devices.

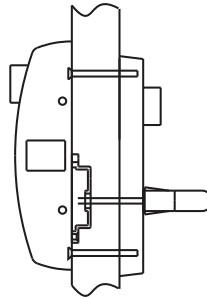

PE8816 RHRB shown

P700 series control used with PE8900 Mortise lock exit devices.

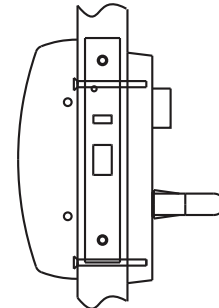

PE8900 RHRB shown

P700-8 series used with PE8500, PE8800, 12-PE8800, PE8888, 12-PE8888, HC-PE8800 and 12-HC-PE8800 rim type exit devices.

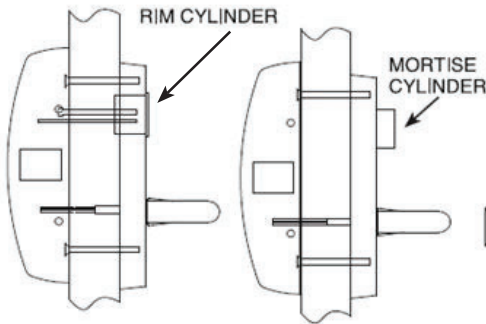

**PE8800 x P775
RHRB shown**

**PE8800 x P713
RHRB shown**

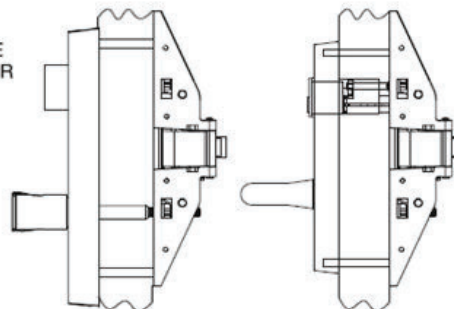

**PE8500 x P713,
P715
LHRB shown**

**PE8500 x P704
LHRB shown**

Important: See instruction sheet A8301 for (12)PE8888 and (12-)HC-PE8800 exit device mounting, or A8302 for PE8500.

P700-4 series trim used with PE8400, 12-MD-PE8400, MD-PE8600, 12-MD-PE8600, WD-PE8600 and 12-WD-PE8600 concealed vertical rod exit devices.

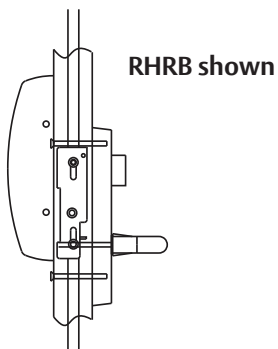

RHRB shown

Important: See instruction sheet for exit device mounting:

A8306 - For PE8400 and 12-MD-PE8400

A8305 - For MD-PE8600 and 12-MD-PE8600

A8315 - For WD-PE8600 and 12-WD-PE8600

P700 NE & P700 WE Series

Lever Handle with Exit Trim

Installation Instructions

SARGENT®

ASSA ABLOY

Trim Lever Handling

1

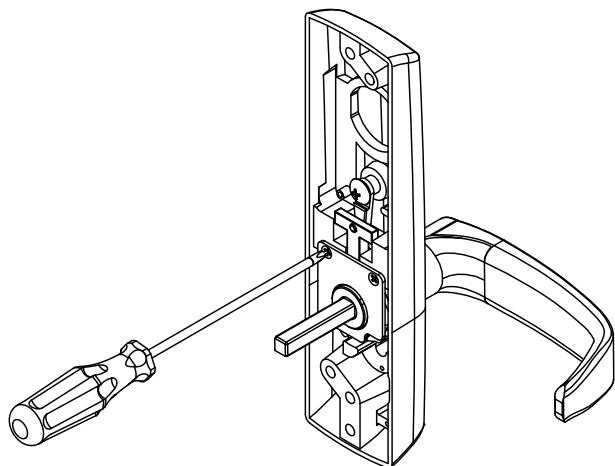

Loosen #4 - 40 x 3/16" flat head screws with a screwdriver.

2

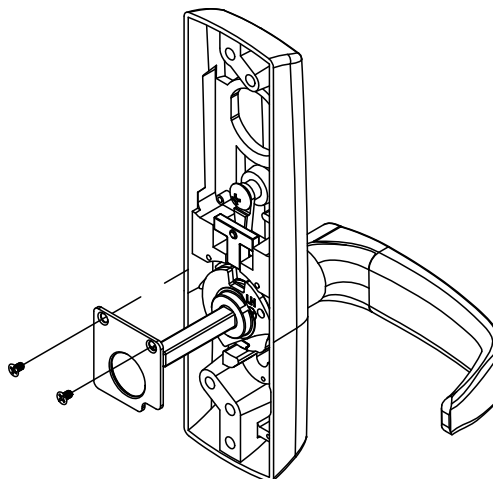

Remove flat head screws and cover plate.

3

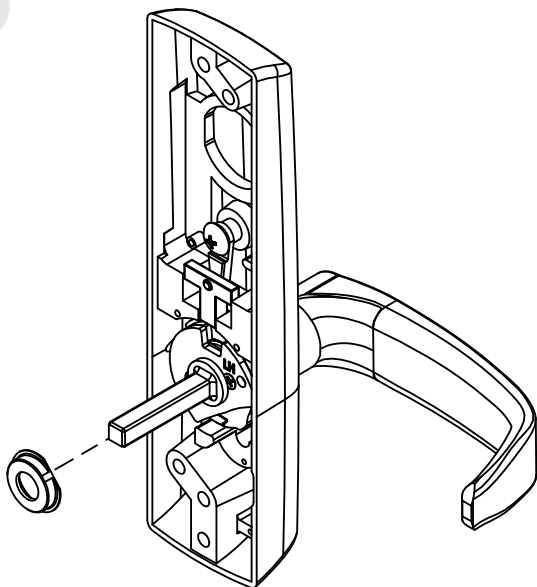

Remove bushing.

4

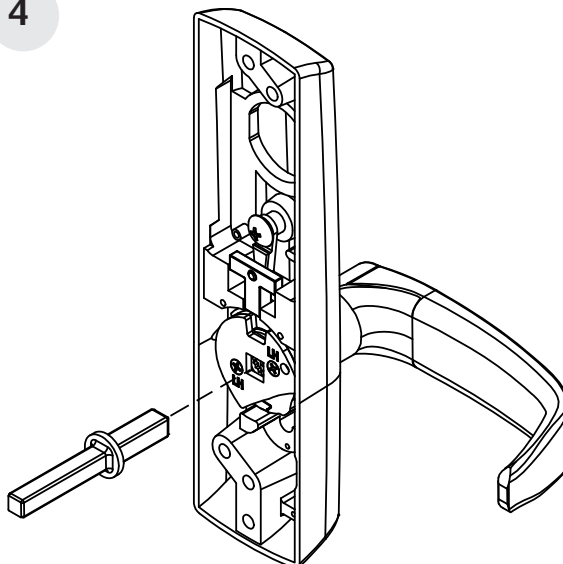

Remove spindle.

P700 NE & P700 WE Series

Lever Handle with Exit Trim

Installation Instructions

SARGENT®

ASSA ABLOY

5

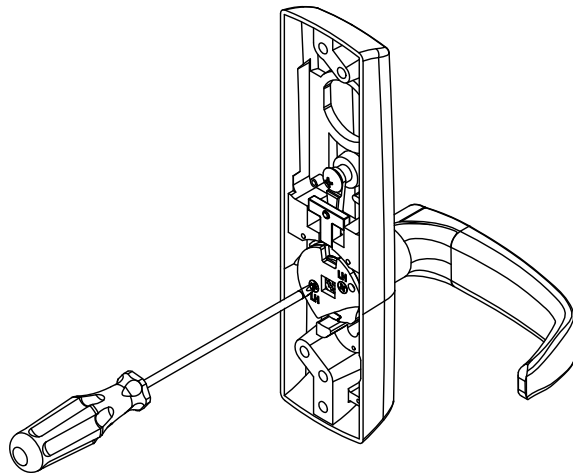

Remove #4 - 40 x 3/16" flat head screws.

6

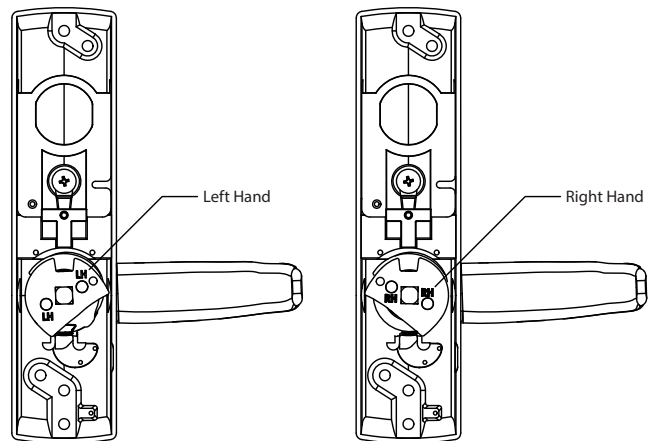

Flip hub plate.

7

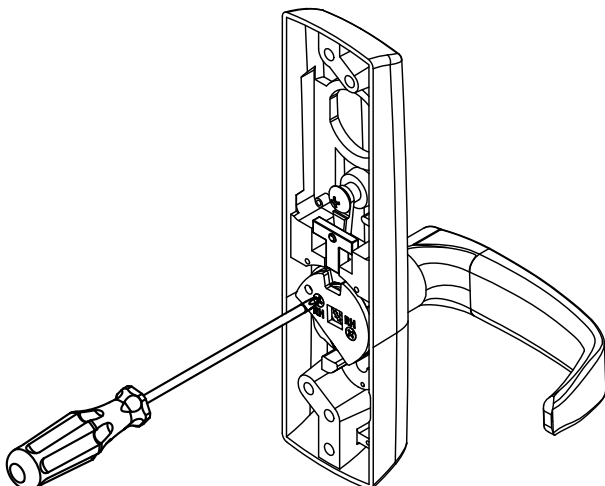

Reinstall flat head screws.

8

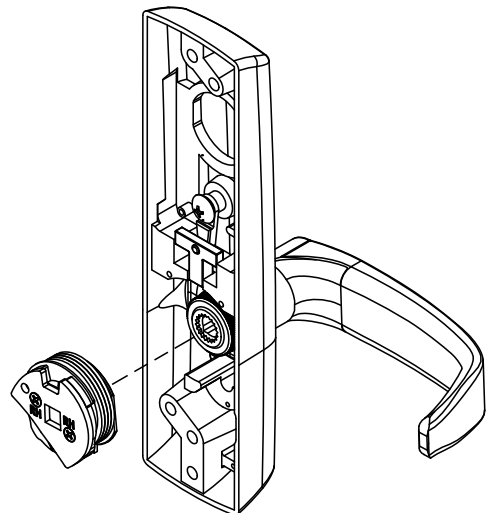

Remove cartridge.

P700 NE & P700 WE Series

Lever Handle with Exit Trim

Installation Instructions

SARGENT®

ASSA ABLOY

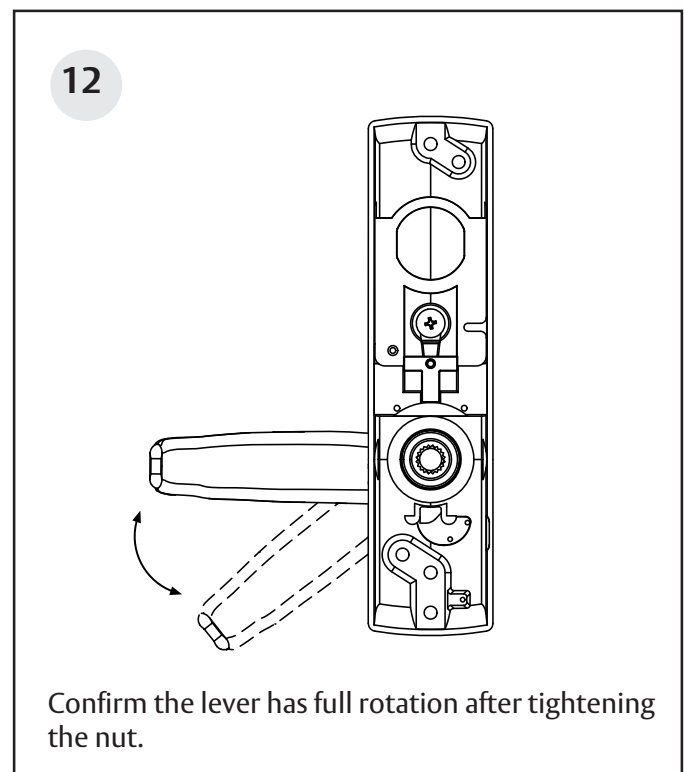
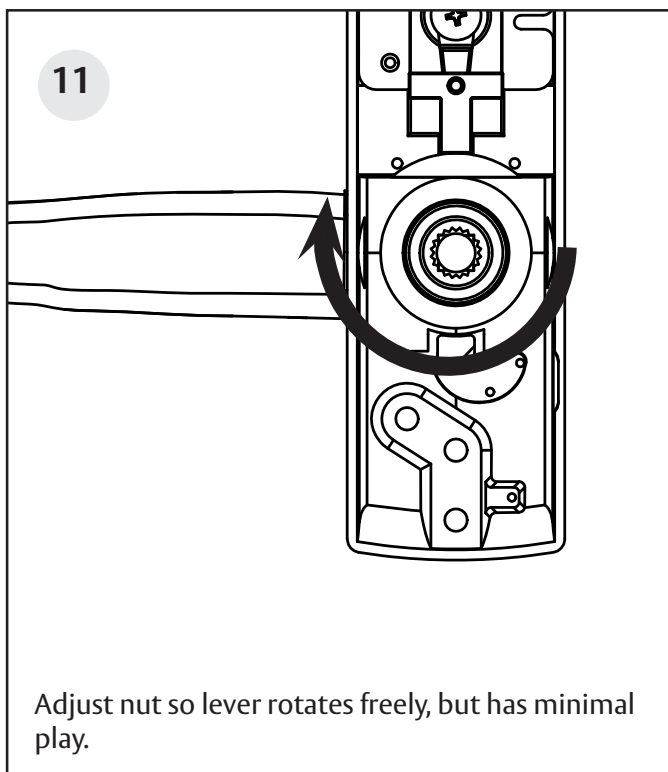
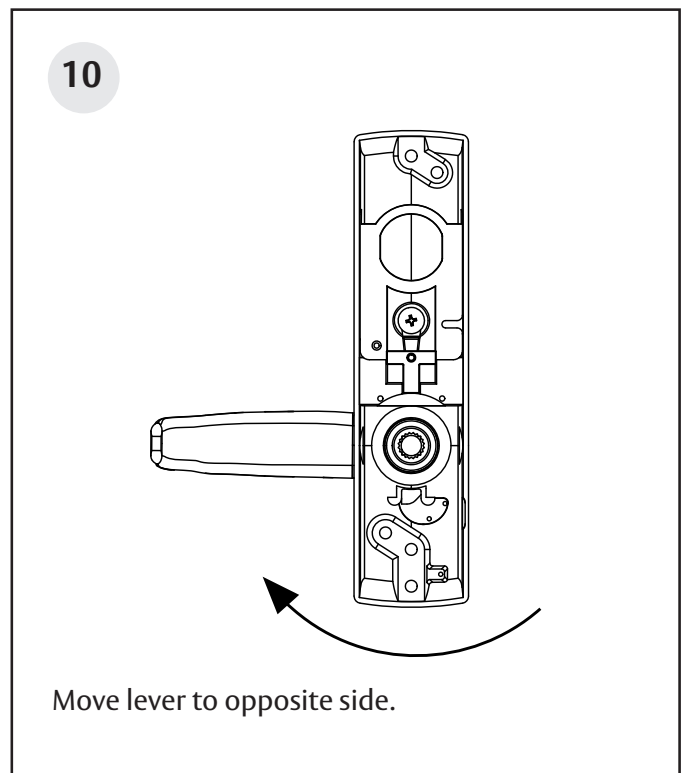
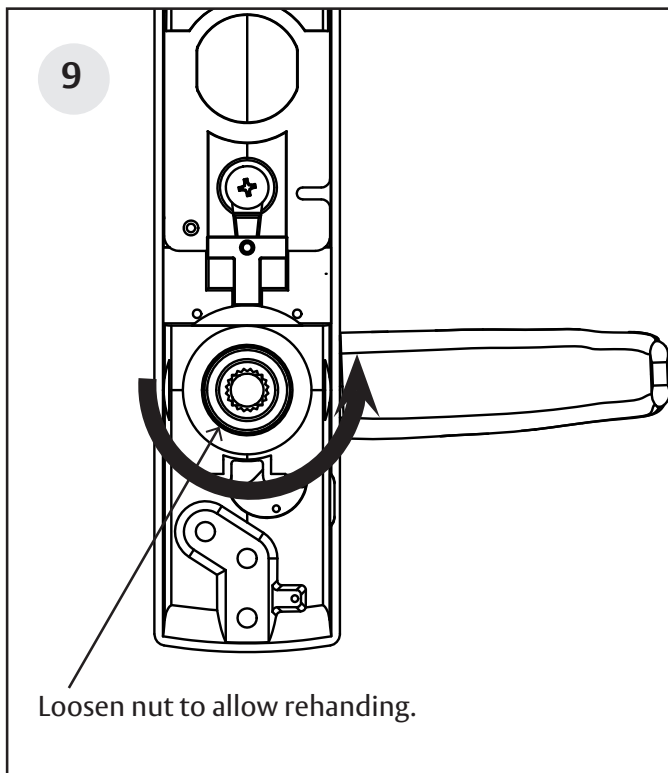

P700 NE & P700 WE Series

Lever Handle with Exit Trim

Installation Instructions

SARGENT®

ASSA ABLOY

13

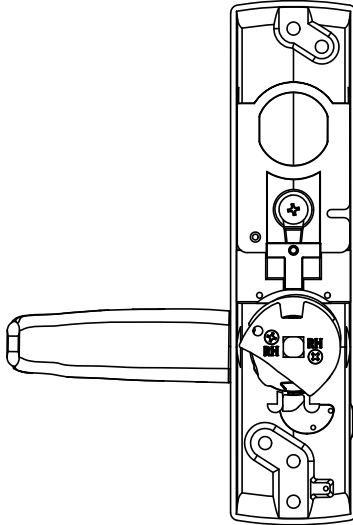

Put cartridge back into trim.

14

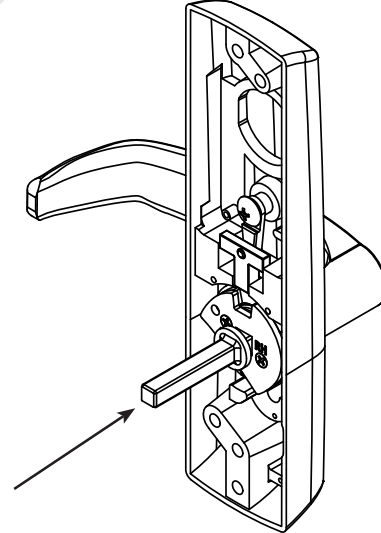

Insert spindle.

15

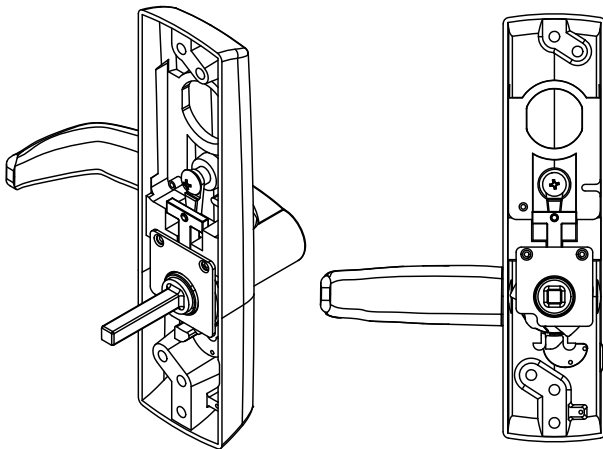

Insert bushing and then insert cover plate.

16

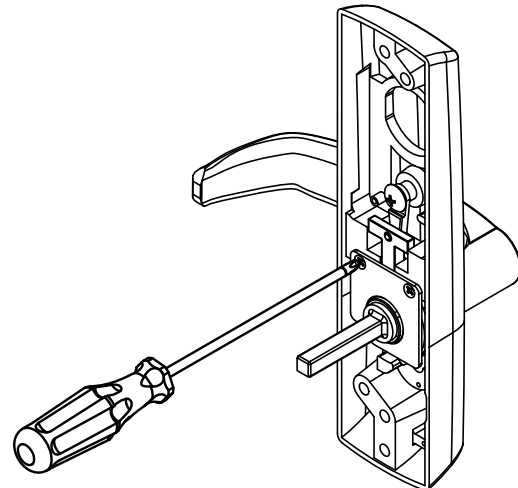

Reinstall #4 - 40 x 3/16" flat head screws.

P700 NE & P700 WE Series

Lever Handle with Exit Trim

Installation Instructions

SARGENT[®]
ASSA ABLOY

