

EXIT DEVICES

6130(F) Series

For technical support contact Yale® at
800.438.1951 x5033 or support@yalelocks.com

80-9460-6004-000 9/15



Installation Instructions for the MORTISE EXIT DEVICE

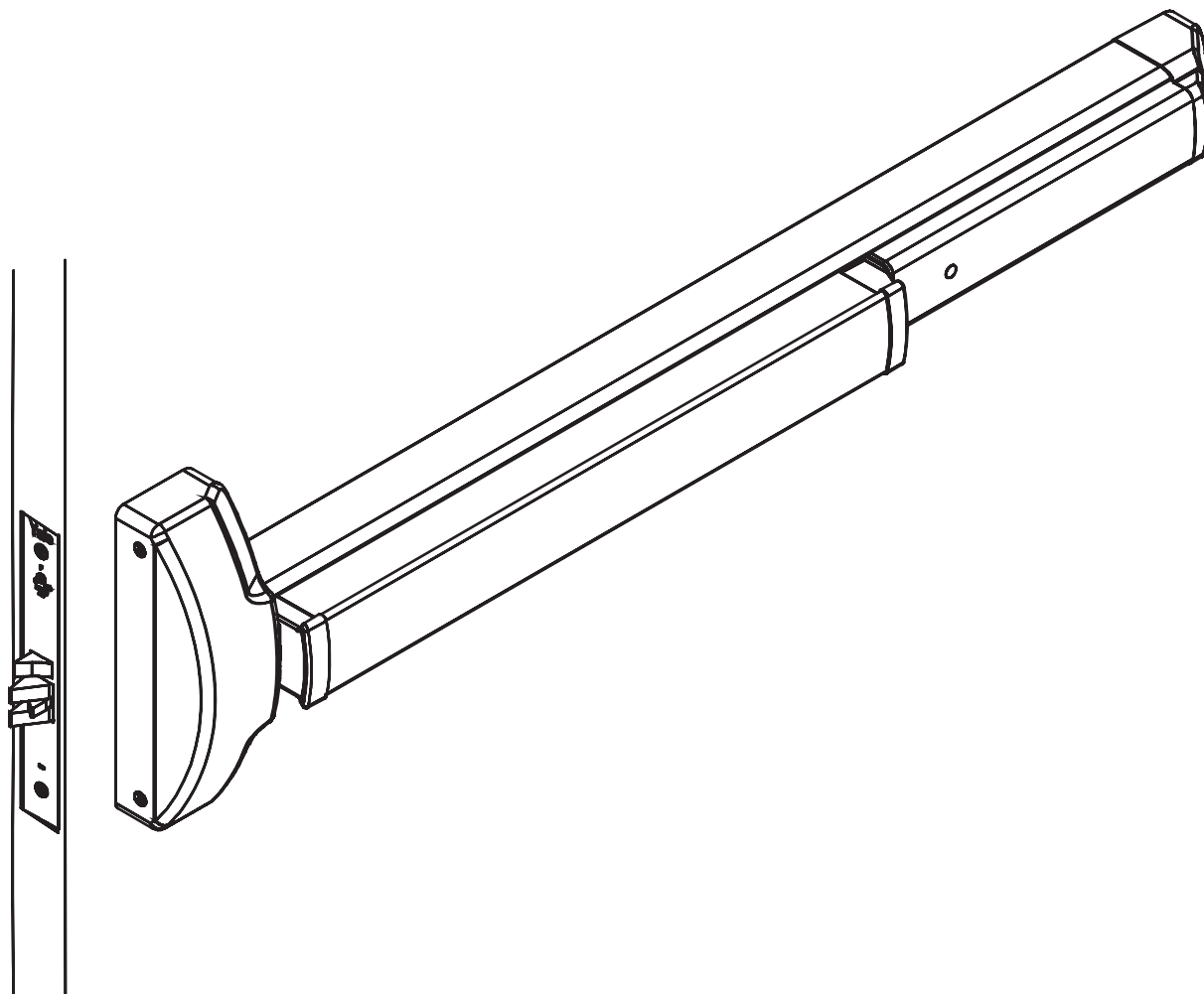

IMPORTANT:

Retrofitting or modifying this device may impact fire rating, safety features and warranty. Consult with code specifications to ensure compliance with all codes and ratings.

NOTE:

These instructions cover standard, reinforced metal doors only. To install options, such as shim kits or interlock brackets, refer to the instructions packed with the optional component. Optional hardware is required for unreinforced metal, composite and wood doors. Device is ready for any applicable Yale trim.

6130(F) Series

*For technical support contact Yale® at
800.438.1951 x5033 or support@yalelocks.com*

80-9460-6004-000 9/15

**Table of Contents**

A	Verify Parts & Templates	3
B	Exploded View	4
C	Before Installation	5
D	Check Mortise Lock Handing	5
E	Door Reference Lines	6
F	Prepare Door & Frame with Templates	6 – 7
G	Install Lockbody (Mortise)	8
H	Install Strike Plate	9
I	Sizing Touch Bar Exit Device	10
J	Install Device Assembly	11
K	Install Rear Clamp & End Cap	12
L	Device Assembly Cover Installation	13
M	Operation & Maintenance	14



A Verify Parts & Templates

1. Unpack and verify components received using the parts list and exploded view.
2. Read entire instructions before installing this device.



IMPORTANT:

- Verify device is being installed on the correct door, as well as function, finish and size.
 - Use site survey to verify correct product ordered.
 - This device is intended to be installed on new 24" (610mm) to 48" (1220mm) metal or wood, pre-drilled, free swinging doors only.
3. Follow all cautions, notes and warnings presented in these instructions.
 4. All dimensions listed are in inches (") and millimeters (mm).

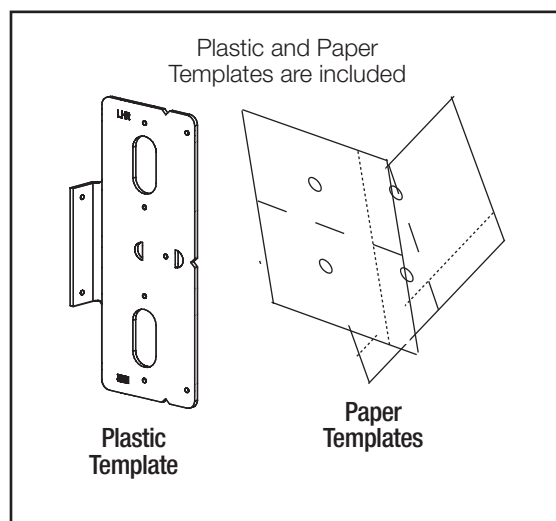

Tools Required



Level



Phillips
Head



1/8" Hex
Key



Tape
Measure



Pencil



Chisel

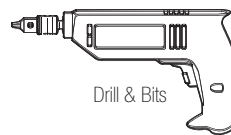

Drill & Bits

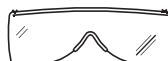

Safety Glasses



Tape

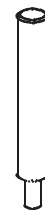

Set Tool



Flashlight

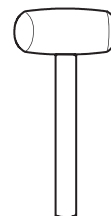

Rubber
Mallet

Exit Devices

6130(F) Series

For technical support contact Yale® at
800.438.1951 x5033 or support@yalelocks.com

80-9460-6004-000 9/15

Yale®

B

Exploded View

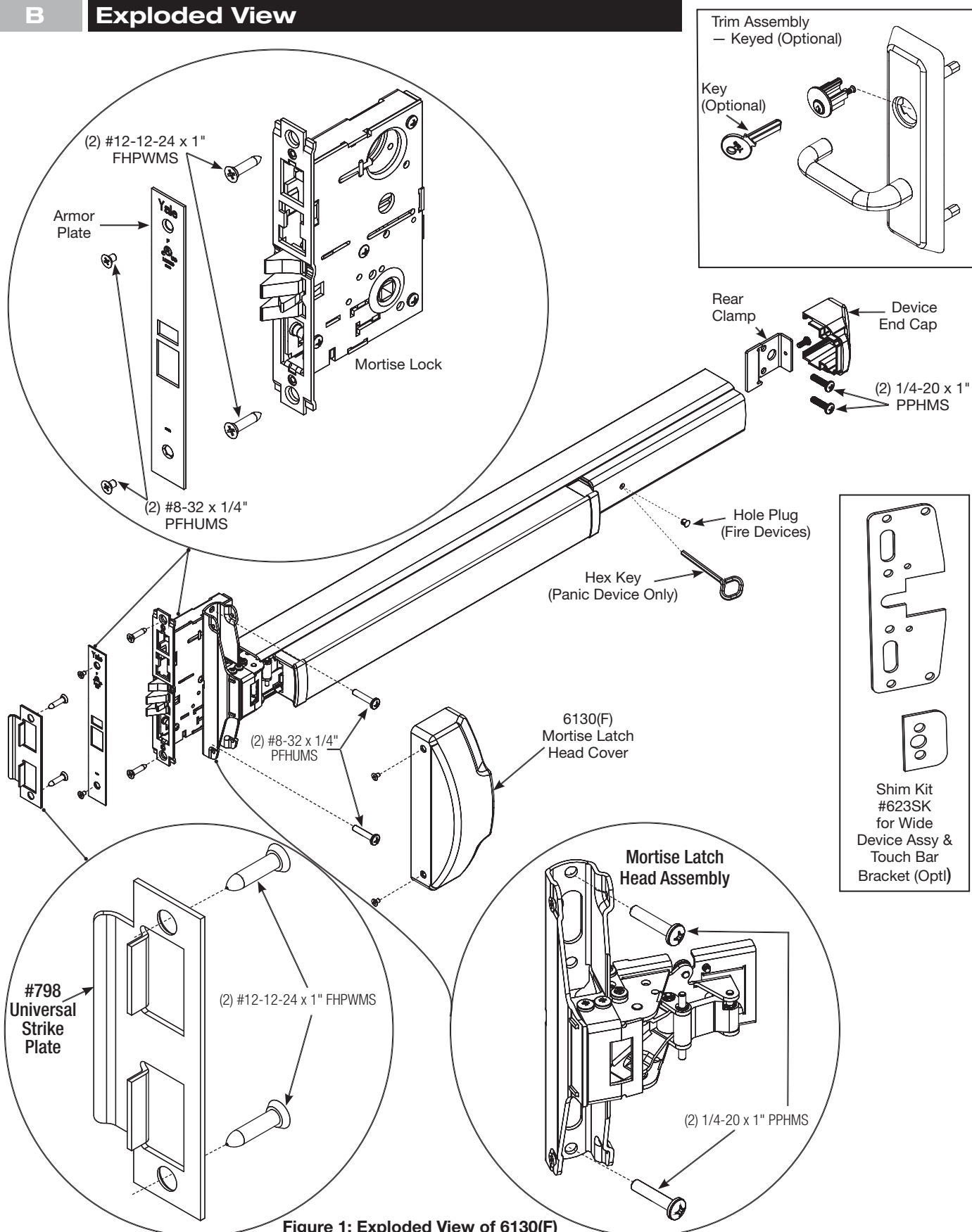

Figure 1: Exploded View of 6130(F)

6130(F) Series

For technical support contact Yale® at
800.438.1951 x5033 or support@yalelocks.com

80-9460-6004-000 9/15



C

Before Installation

1. Make sure the door is plumb and level. Check that the hinges are secure and not missing hardware (see Figure 2).
2. If surface of the door is free of raised projections, device may be installed without a shim kit. One (1) shim kit is needed for each 1/4" of projection:
 - 6130(F) - 623SK
3. Fully open the doors to ensure doors do not hit floor as they swing.
4. Determine if door is reinforced. Door and frame thickness must have three (3) full screw threads to be considered reinforced.

**IMPORTANT:**

- For unreinforced doors use SNBs (Sex Nuts and Bolts).
- For unreinforced frames use Blind Rivet Nuts.

D

Check Mortise Lock Handing

1. To change lock handing, remove screws on lockbody, open cover and remove flip/latchbolt and guardbolt (see Figure 3).

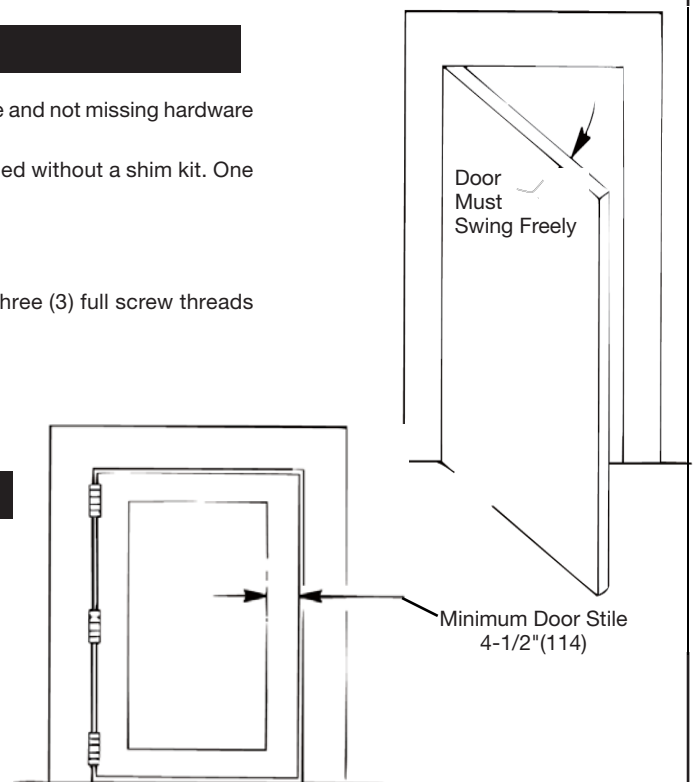

Figure 2: Installation Check

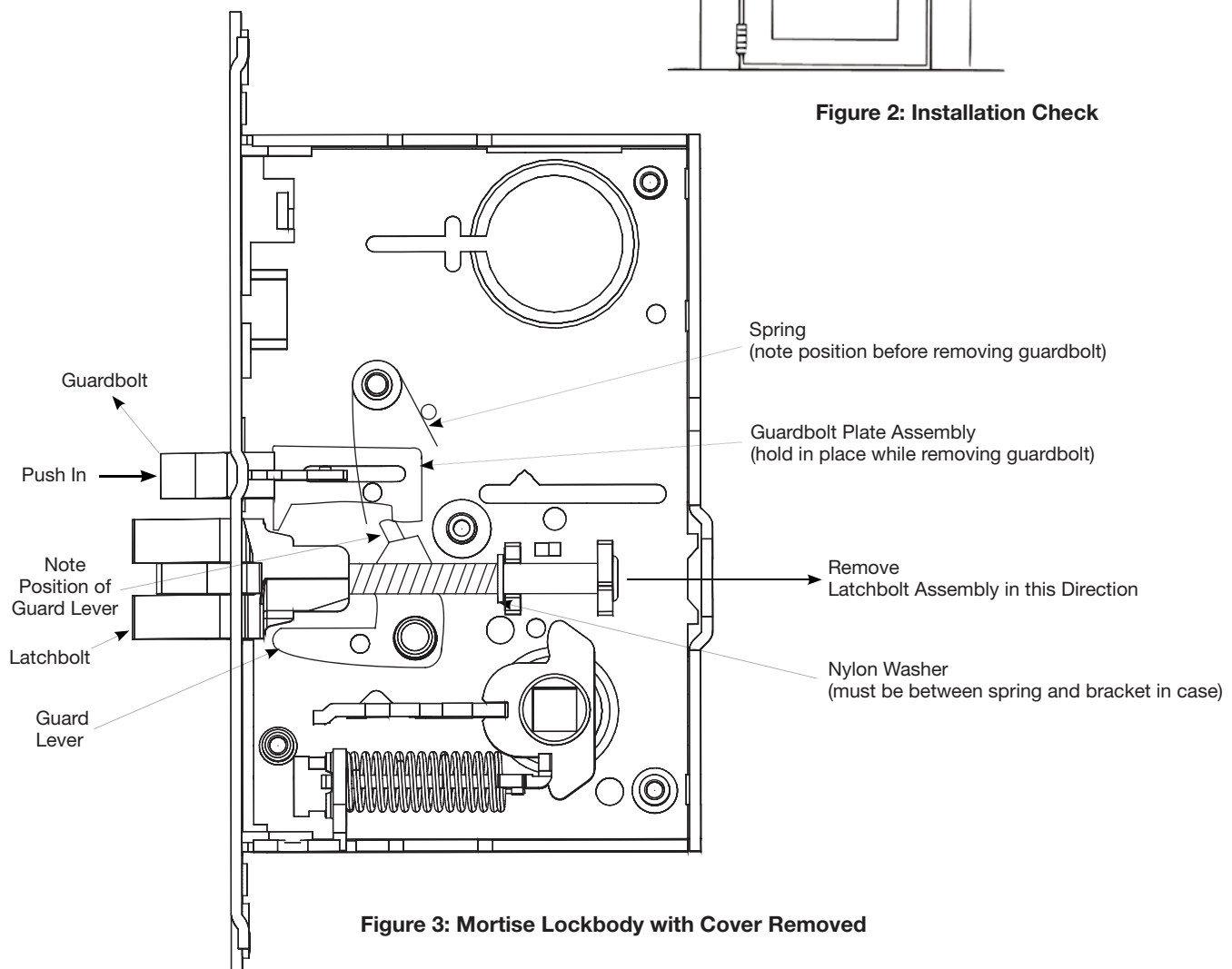

Figure 3: Mortise Lockbody with Cover Removed



E Door Reference Lines

1. Backset is measured from centerline of bevel which is centerpoint of door thickness (Figure 4-A).
2. Locate and mark horizontal centerline and vertical centerline as shown.

NOTE:

- Standard rail centerline height is 39-15/16" (1015mm) above finished floor.
- Centerline of lock must match Horizontal Reference Centerline.

F Prepare Door & Frame with Templates

Continued on next page...

Prepare the door and frame with templates (Figure 4-A).

NOTE:

If factory prepared cutouts with field drilled mounting holes are in the door, skip to: Section G: Install Lockbody (Mortise). If the door (lock) and frame (strike) need to be mortised in the field, continue with Step F instructions.

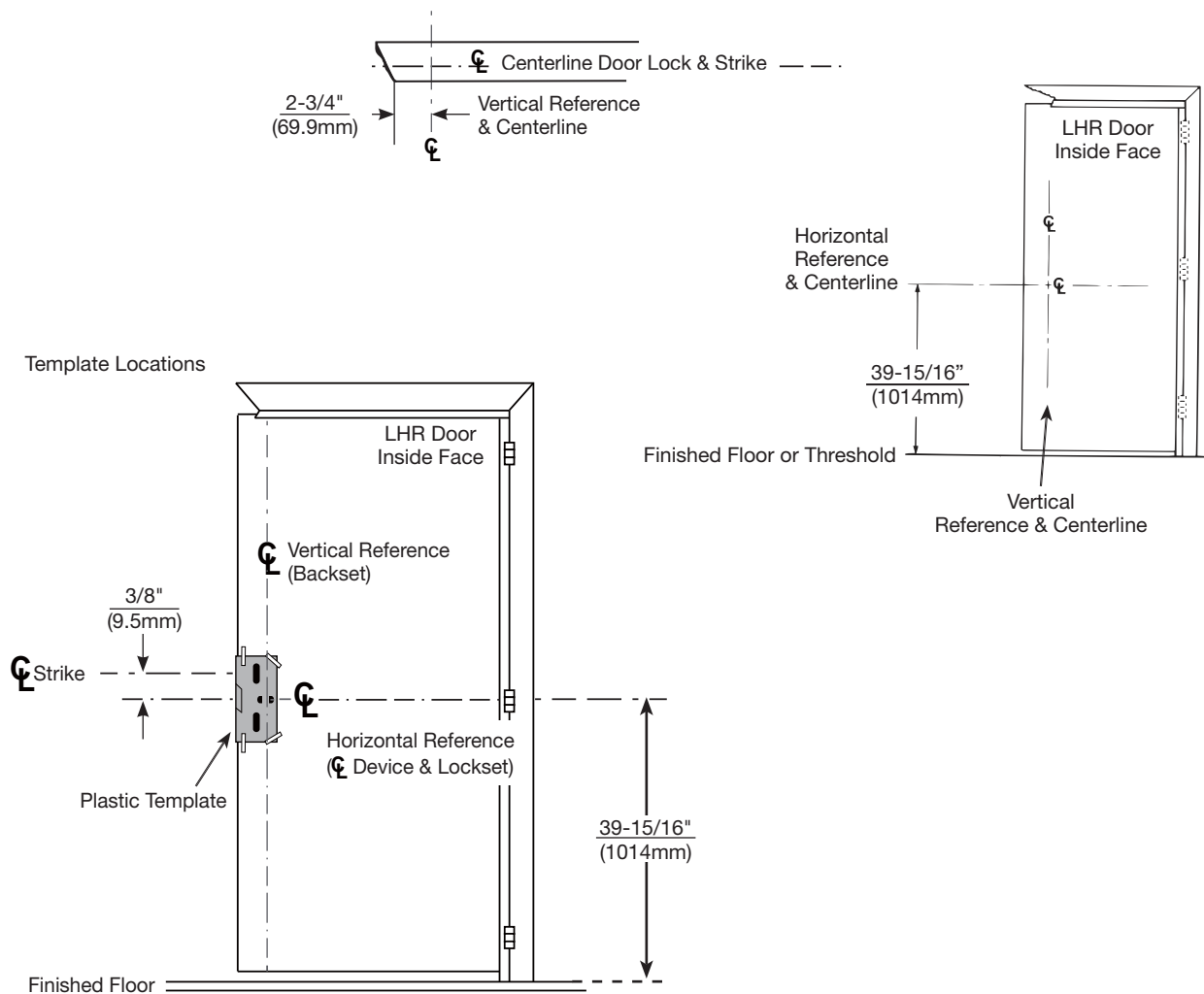

Figure 4-A: Prepare Door & Frame with Templates

F

Prepare Door & Frame with Templates

Continued from previous page.

Plastic Template

Prepare mounting holes as follows:

1. Use plastic template provided and position on door and frame. Align vertical and horizontal reference centerlines on door with notches on template (see Figure 4-B).
2. Tape template to door face. Mark door per template.
3. If trim is used, locate templates packed with trim. Position templates and mark holes per trim instructions.
4. Drill and tap only those holes needed for the device being installed (see Table 1).
5. Ensure that the latch assembly lever hole is predrilled to accommodate latch lever.
6. Check by inserting lock into door, adjust front for door edge (beveled or flat, reference Section D: Check Mortise Lock Handing).

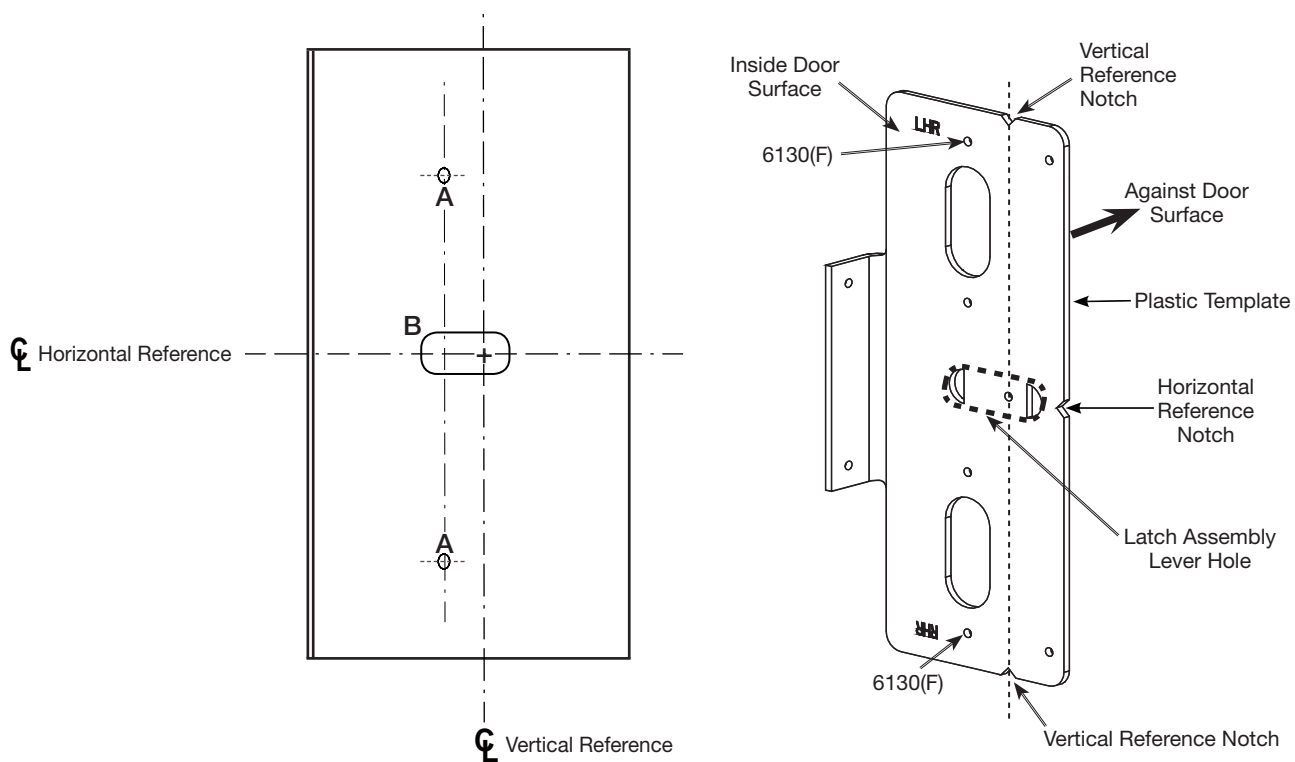

Figure 4-B: Prepare Door & Frame with Templates

Table 1: Door & Frame Preparation

Hole	Door/Frame	Fastener	Preparation
A	Metal Reinforced	1/4-20 PPHMS	Drill: #7(Ø 0.201") Tap: 1/4-20
	All Others	1/4-20 SNB	Drill: Ø 3/8" thru
B	All	—	OB 1/2" x 1-9/16"

G

Install Lockbody (Mortise)

1. With lockbody in door cavity, fasten to door edge with two (2) 12-12-24" FHPWMS. Leaving screws loose two (2) full turns (Figure 5).
2. Check that latchbolt and deadbolt (optional) retract and extend freely.

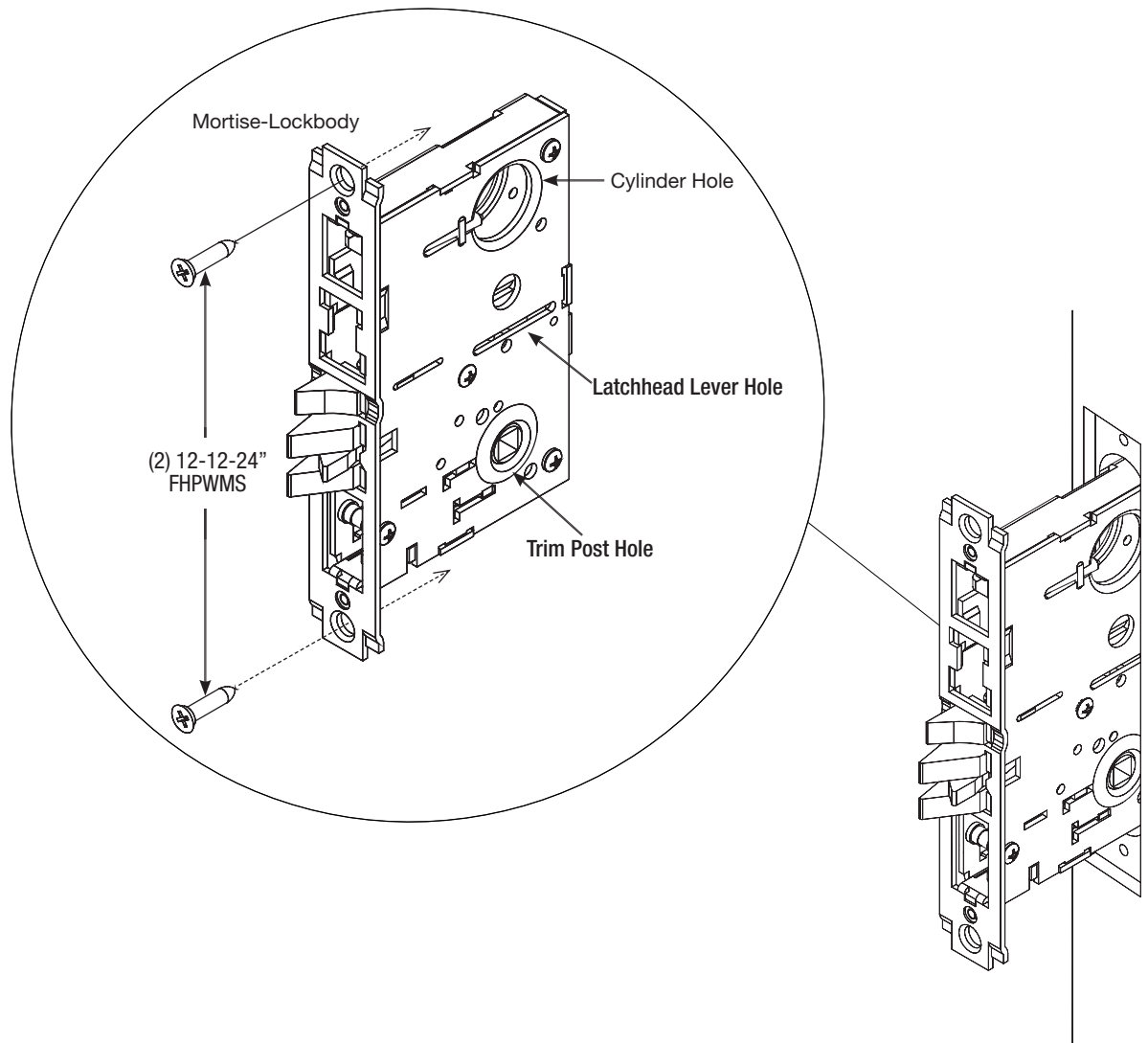

Figure 5: Install Lockbody (Mortise)



H

Install Strike Plate

1. Locate strike by marking horizontal centerline of the device onto frame (see template).

NOTE:

Strike centerline is 3/8" (9.5mm) higher than device centerline (Figure 6-A).

2. Fasten the strike securely with two (2) #12-12-24 x 1" (25.4mm) FHPWMS (Figure 6-B).
3. Close door and check bolt engagement onto strike.
 - a. Bolt should retract to clear strike when device assembly lever is depressed.
 - b. Bolt should re-engage the strike when device assembly lever is released and door is shut.
 - c. Door should remain latched and should not rattle when pushed, pulled or shaken.

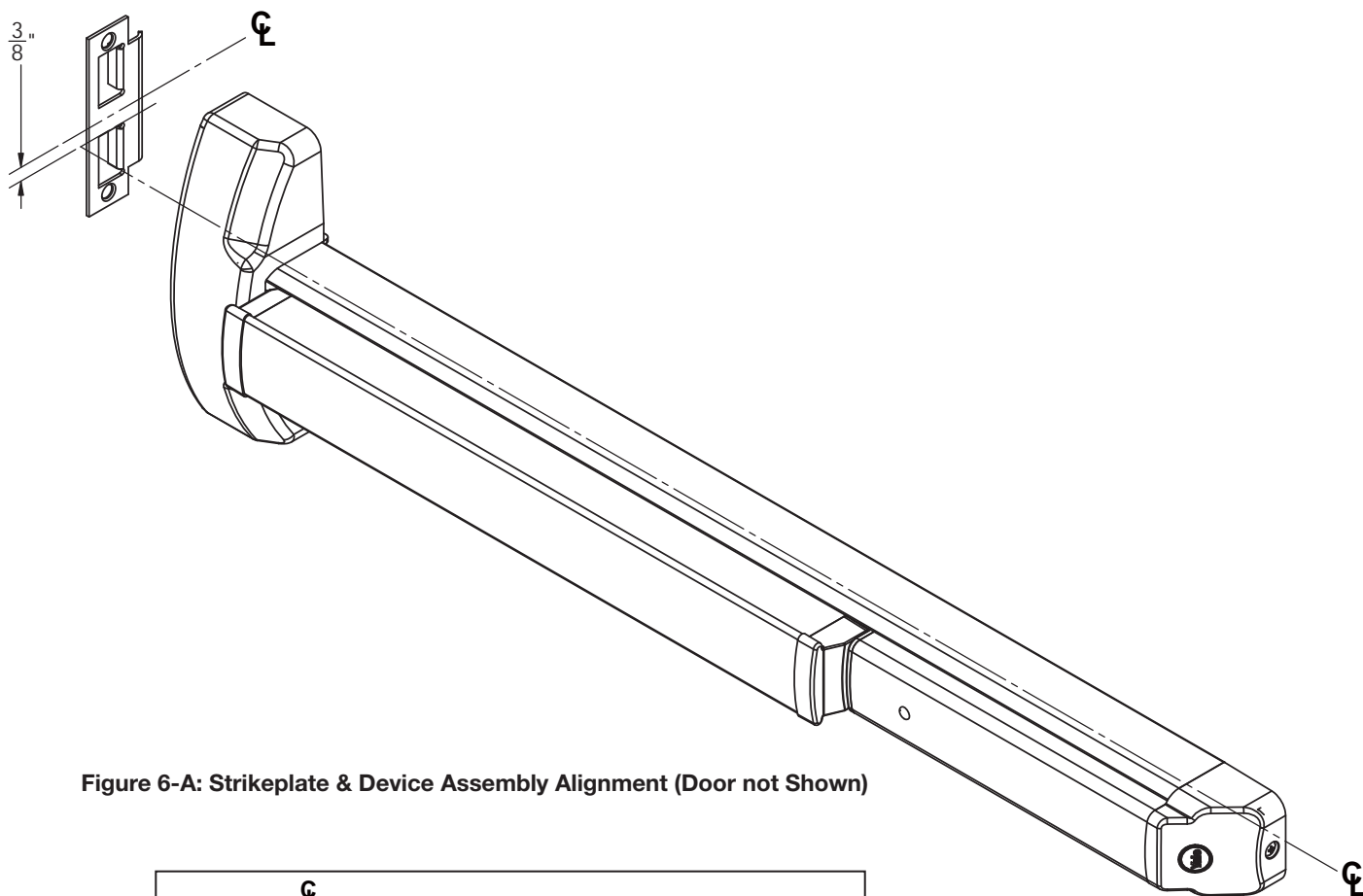

Figure 6-A: Strikeplate & Device Assembly Alignment (Door not Shown)

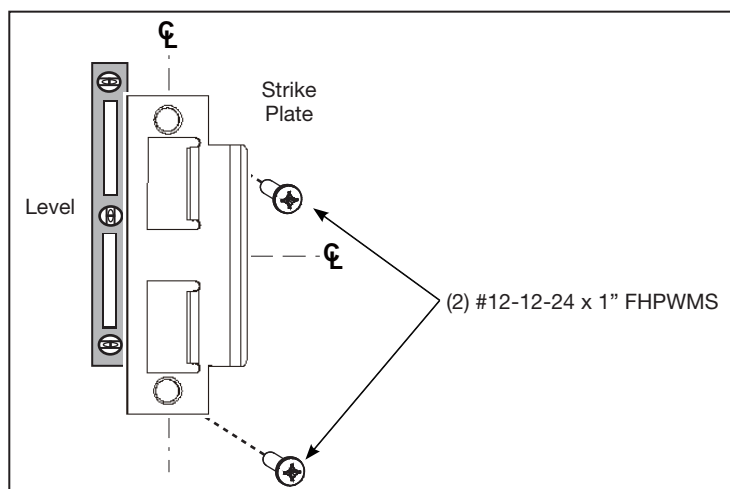

Figure 6-B: Strikeplate & Device Assembly Alignment

**I****Sizing Touch Bar Exit Device**

1. Bar must be cut to size if gap between bar and stop surface is less than 2-7/8" (Table 2).
2. With door closed, measure 2-7/8" (73mm) from stop surface on hinge side of door. Mark vertical reference line on door (see Figure 7).
3. Open door. Align mounting holes in latch head with mounting holes in the door. Mark device where it crosses the mark from step 2.

NOTE:

For devices with dogging, hole must be at least 1-5/8" (41.3mm) from edge of bar.

4. Before cutting, ensure end cover is in place and there is no gap between the cover and the touch bar. Cut touch bar on mark from step 3.

Table 2: Standard Device Sizing				
Catalog Size	Door Width		Precut Lengths	
	Minimum	Maximum	Narrow	Wide
24	24" (610)	24" (610)	—	18.426" (468mm)
36	30" (762)	36" (915)	32.196" (818)	30.426" (773mm)
42	37" (940)	42" (1067)	38.196" (970)	36.426" (925mm)
48	43" (1092)	48" (1920)	44.156" (1122)	42.036" (1068mm)

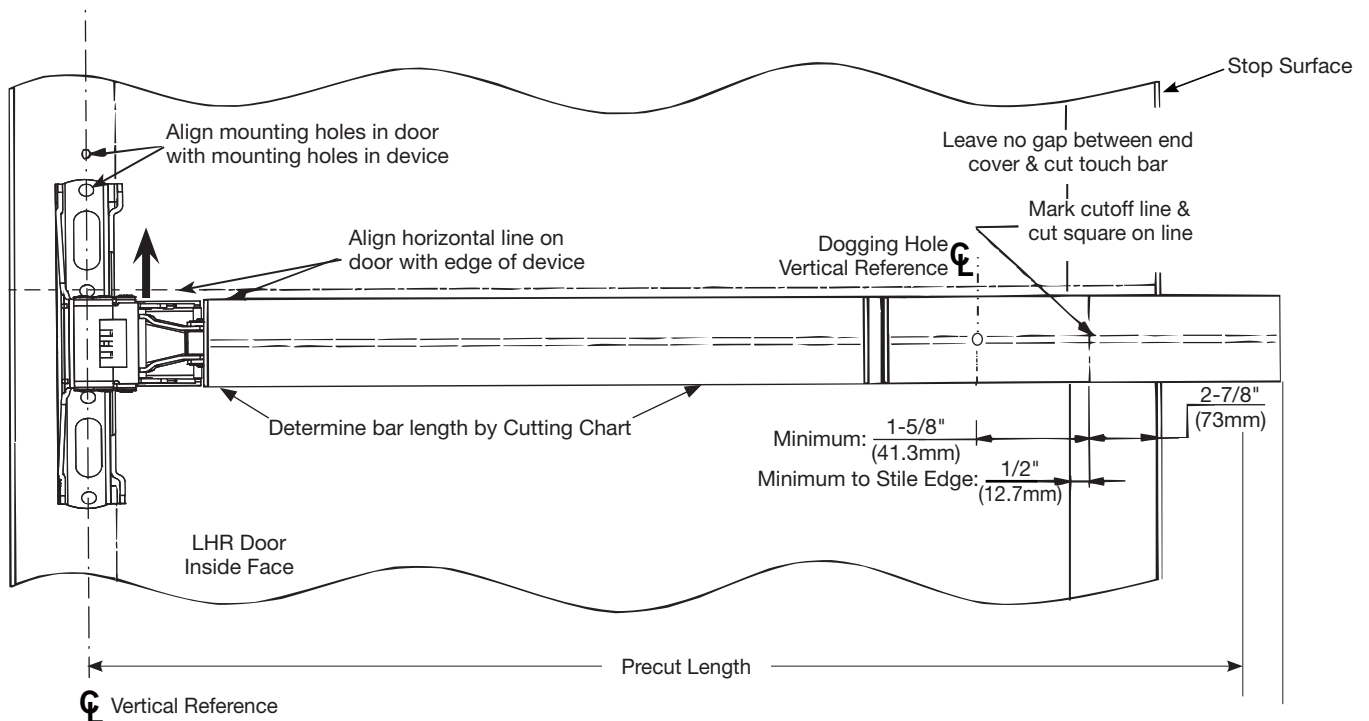
**Figure 7: Sizing Touch Bar Exit Device**



J

Install Device Assembly

**IMPORTANT:**

First determine if shim kit is needed for door face (see Section C: Before Installation).

1. Mount trim following instructions packed with trim (optional).

NOTE:

If installing a cylinder, it may be necessary to leave the two (2) mortise lock screws (Section G: Install Lockbody (Mortise)) loose and the lockbody tipped toward the cylinder side of the door. After installing the cylinder, tighten the lock mounting screws.

2. Seat lever from back of device assembly into slot in lockbody (Figure 8-A).
3. Ensure lever engages latchbolt.
4. Loosely attach device assembly to door using two (2) 1/4-20 x 1" (25.4mm) PRHMS (Figure 8-B).
5. Level device and partially tighten screws (Figure 8-C).

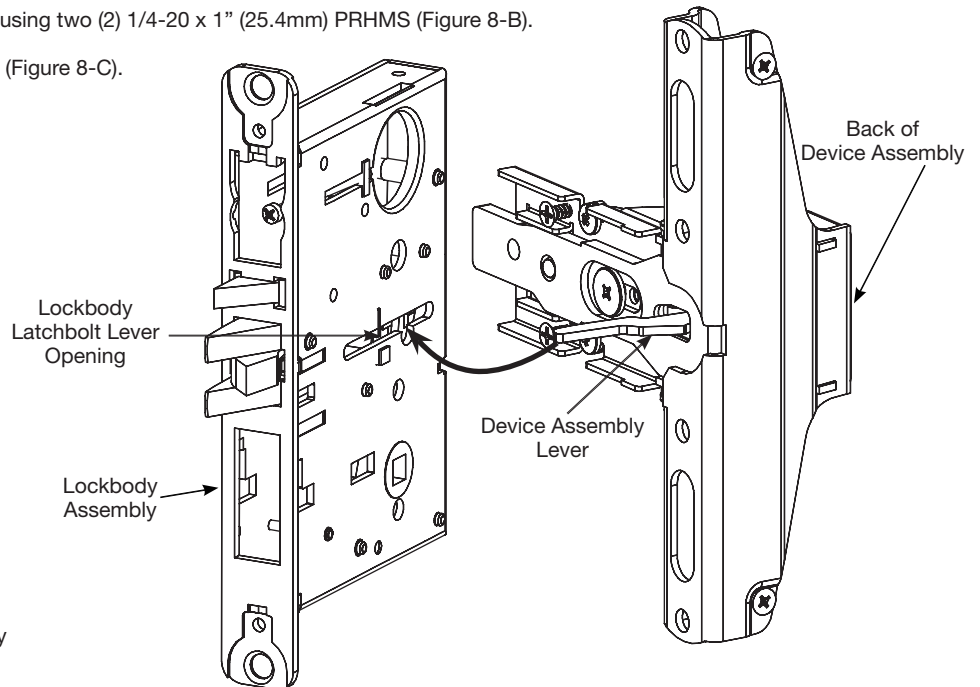

Figure 8-A: Install Device Assembly (Door not Shown)

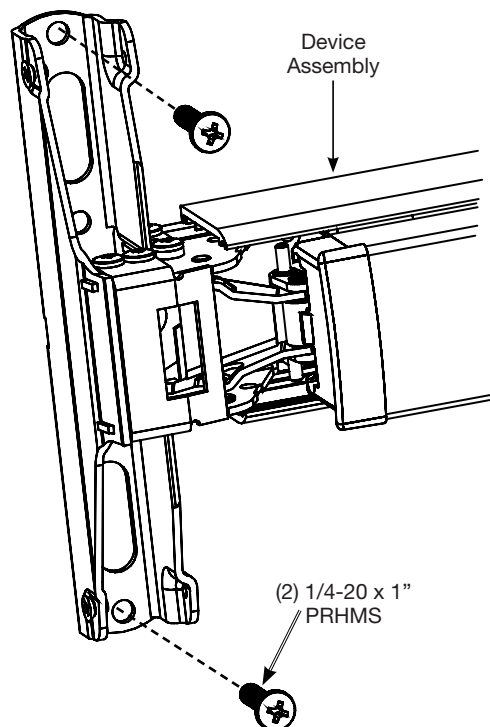

Figure 8-B: Attach Device Assembly (Door not Shown)

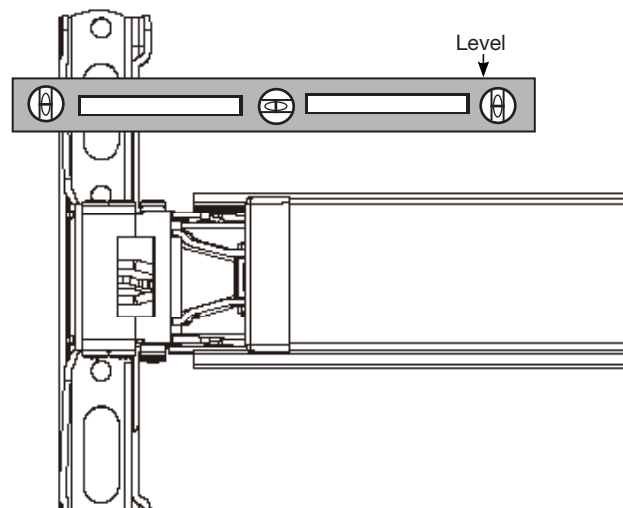

Figure 8-C: Level Device Assembly



K Install Rear Clamp & End Cap

1. With device leveled, insert rear clamp, locate holes and mark (ensure rear clamp is pushed flush against device). See Figure 9.
2. Using the rear clamp as a template, mark and drill holes for two (2) 1/4-20 screws.
3. Install rear clamp screws and fully tighten all device and previously installed screws.
4. Slide end cap in place and secure with one (1) #10-24 x 1/2" (12.7mm) PRHMS.
5. Check latch retraction on device as follows:
 - a. Depress touch bar (latch must retract). Release touch bar (latch must extend).
 - b. Actuate trim (latch must retract). Release trim actuator (latch must extend).
 - c. While depressing touch bar, turn dogging key CLOCKWISE. Release touch bar (bar must remain depressed, latch must remain retracted).
 - d. While depressing touch bar, turn dogging key COUNTERCLOCKWISE. Release touch bar (bar and latch must return to extended position).

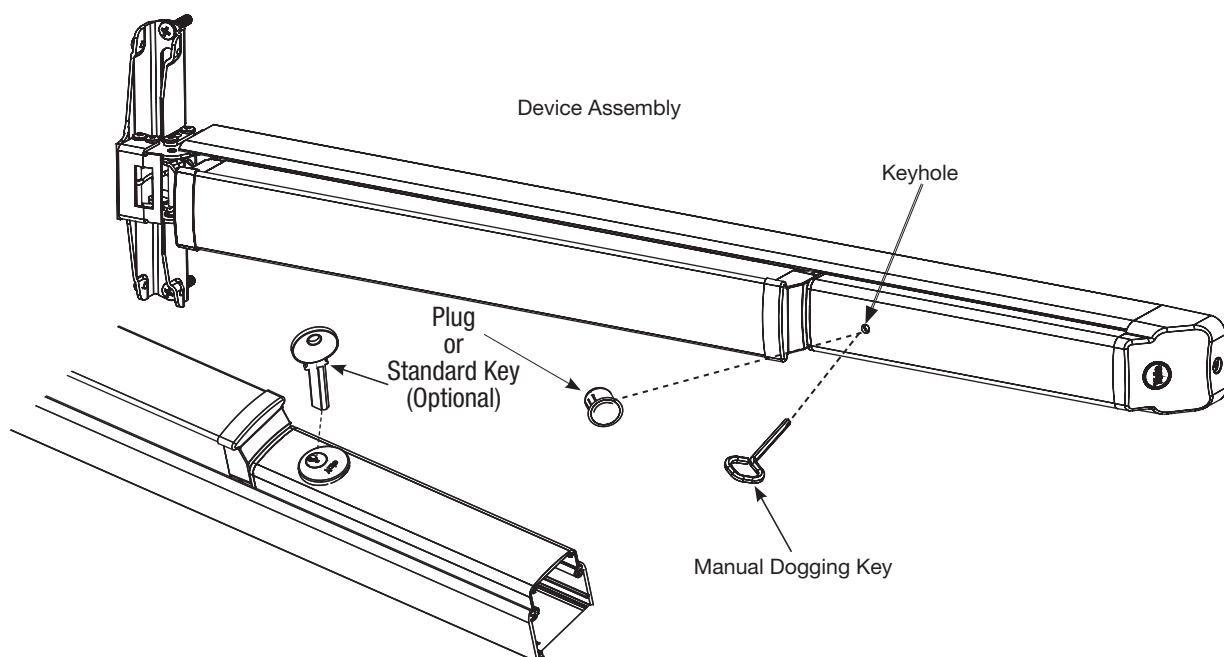
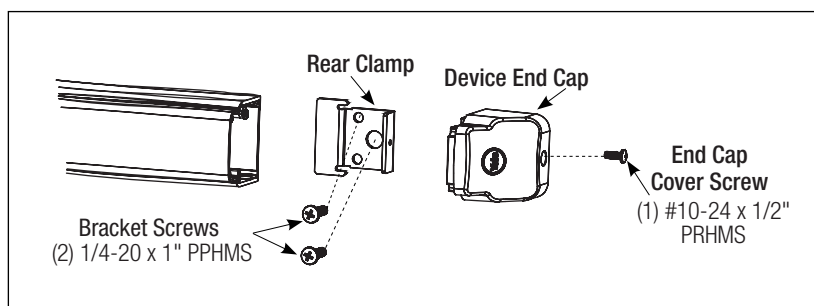
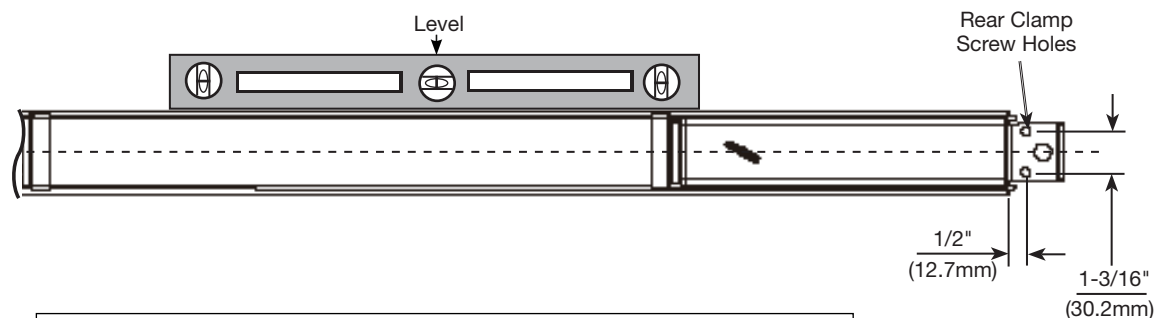

Figure 9: Install Rear Clamp & End Cap



L

Device Assembly Cover Installation

1. Secure latch head cover with two (2) #8-32 x 1/4" (6.35mm) PFHUMS (Figure 10).
2. Install armor plate with two (2) #8-32 x 1/4" (6.35mm) PFHUMS to lockbody.

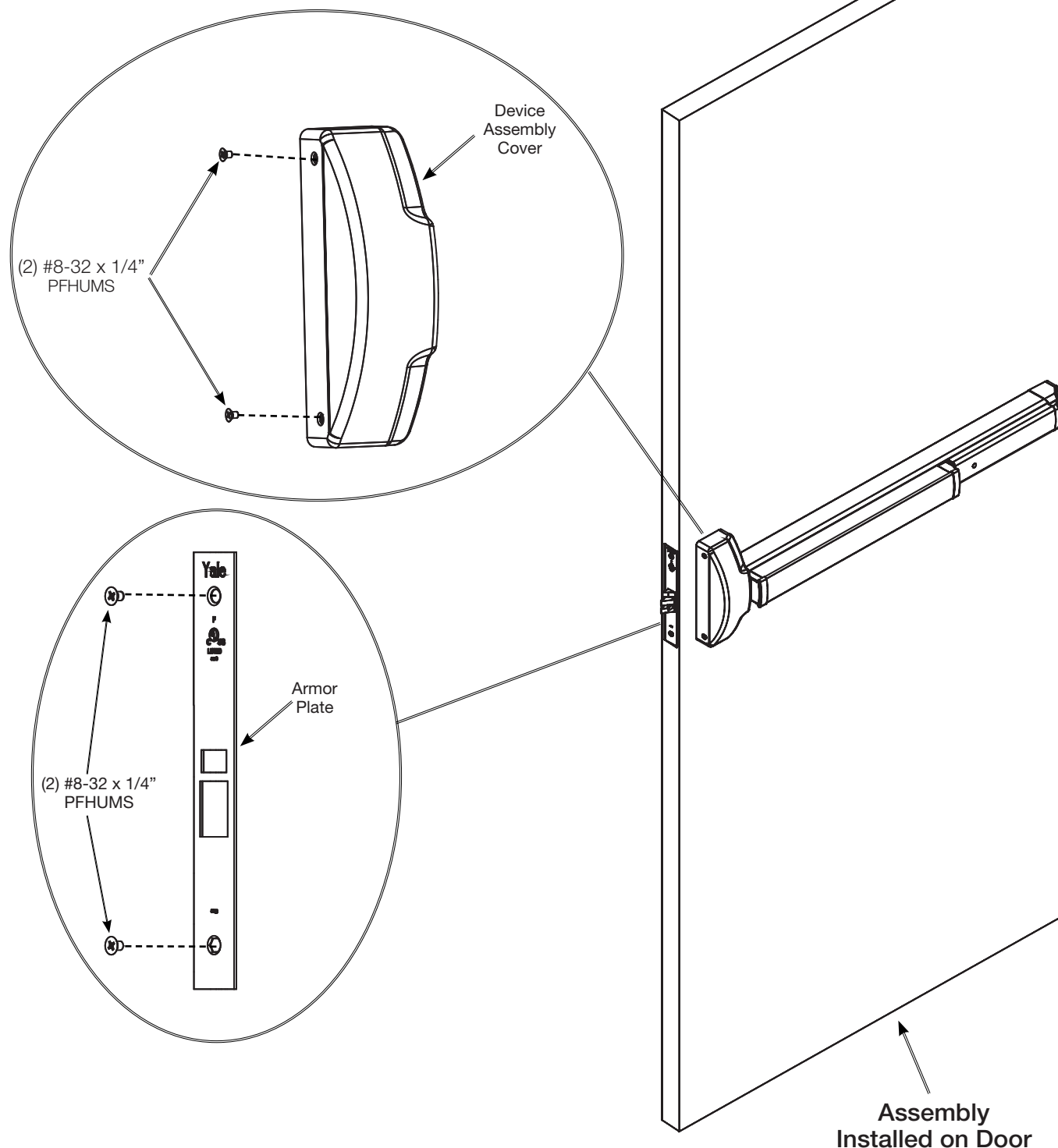

Figure 10: Device Assembly Cover Installation

6130(F) Series

For technical support contact Yale® at
800.438.1951 x5033 or support@yalelocks.com

80-9460-6004-000 9/15



M

Operation & Maintenance

1. Finally, check and inspect operation of:
 - Trim and touch bar
 - Strike plate and bolt engagement
 - Key (optional)
2. Periodically remove covers, inspect and coat mechanisms with a silicone-based lubricant. This is required in corrosive environments for proper functionality.
3. Check mounting fasteners periodically and tighten if loose. Apply screw locking compound or change part fasteners if screws continue to back out.
4. Periodic checks (and adjustments) of strikes are required to compensate for wear-and-tear (e.g. door sagging).

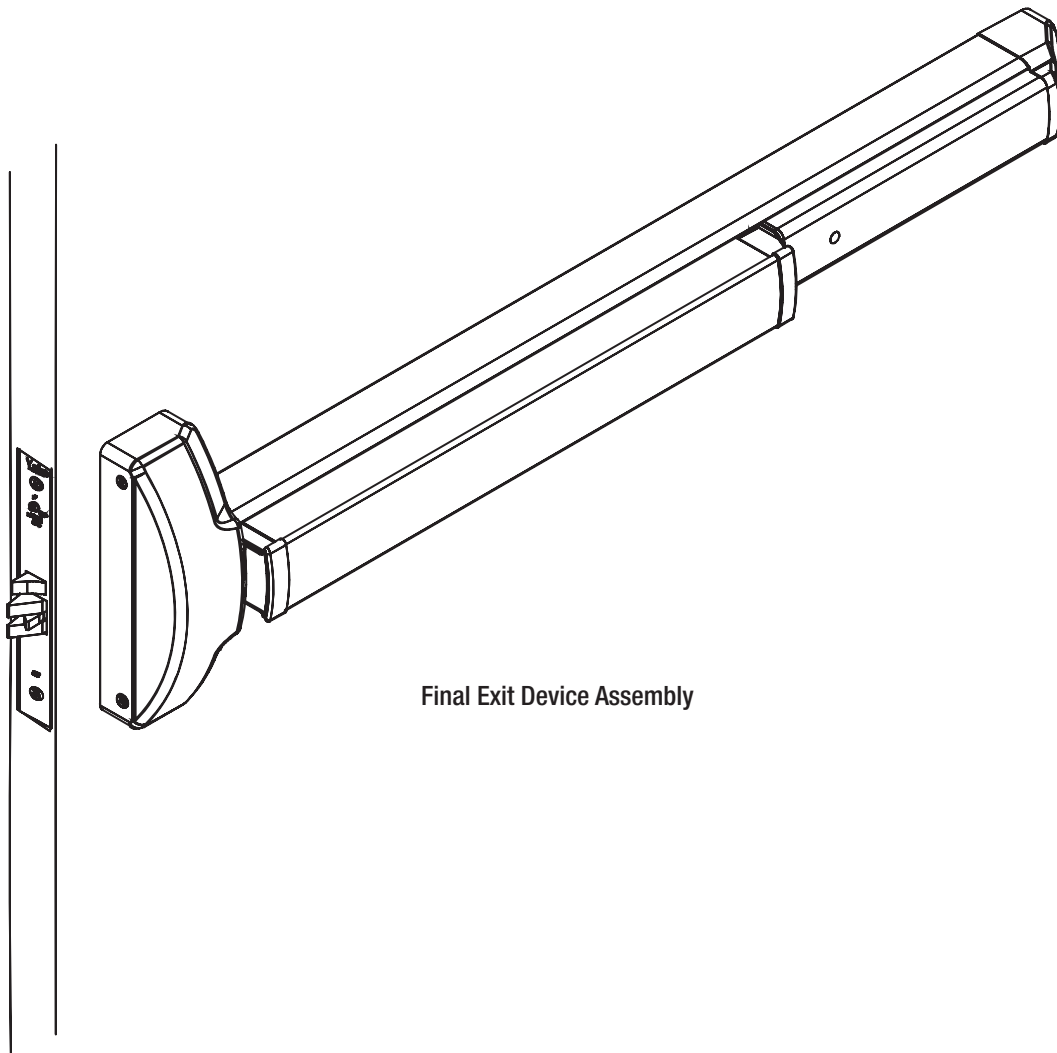

Final Exit Device Assembly

EXIT DEVICES

6130(F) Series

*For technical support contact Yale® at
800.438.1951 x5033 or support@yalelocks.com*

80-9460-6004-000 9/15



Notes

Yale Locks & Hardware
Product Support Tel 800.438.1951 • www.yalelocks.com

Yale Locks & Hardware is a division of Yale Security Inc., an ASSA ABLOY Group company.

Yale® is a registered trademark of Yale Security Inc., an ASSA ABLOY Group Company.
Other products' brand names may be trademarks or registered trademarks of their respective owners and are mentioned for reference purposes only.
These materials are protected under U.S. copyright laws.
All contents current at time of publication. Yale Security Inc. reserves the right to change availability of any item in this catalog, its design, construction, and/or its materials.
Copyright © 2015 Yale Security Inc., an ASSA ABLOY Group Company.
All rights reserved.
Reproduction in whole or in part without the express written permission of Yale Security Inc. is prohibited.