

6000 Series Shim Kits

For technical support contact Yale® at
800.438.1951 x5033 or support@yalelocks.com

80-9460-6008-000 9/15

Yale®

Installation Instructions for the SHIM & ANTI-PRY KITS

For use with all 6000 Series Exit Devices

NOTE:

- Shim kits are provided for use on all 6000 exit devices.
- All kits are optional and are used to level the product components on the surface of the door to ensure proper closure.

1. Each standard shim kit contains two (2) sets of 1/8" thick shims.
2. Use one (1) shim for each 1/8" (3mm) of device lift needed. When mounting the device, use longer screws provided.
3. Before mounting the device in place on the door, position the shims behind the device assembly and the rear clamp, as shown in the instructions provided.

Tools Required

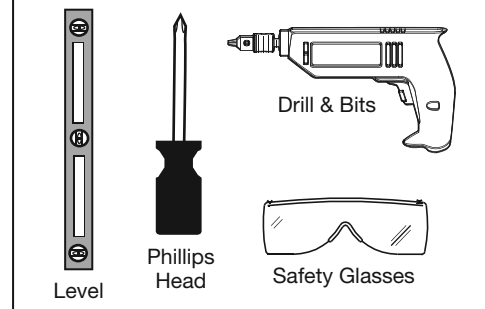

Anti-Pry Kit # 625AP
For Latch Head &
Touch Bar Bracket
(Optional)

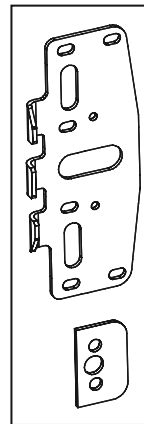

Shim Kit # 623SK
For Latch Head &
Touch Bar Bracket
WIDE (Optional)

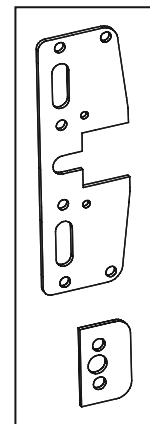

Shim Kit # 623NS
For Latch Head &
Touch Bar Bracket
NARROW (Optional)

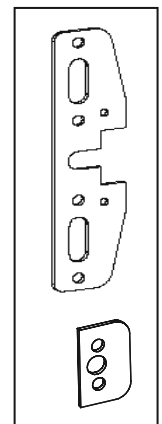

Shim Kit # 624SK
For Latch Head and
Touch Bar Bracket
WIDE (Optional)

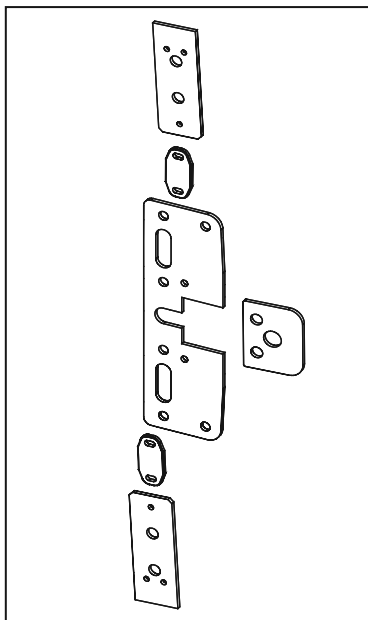

Shim Kit # 624NS
For Latch Head and
Touch Bar Bracket
NARROW (Optional)

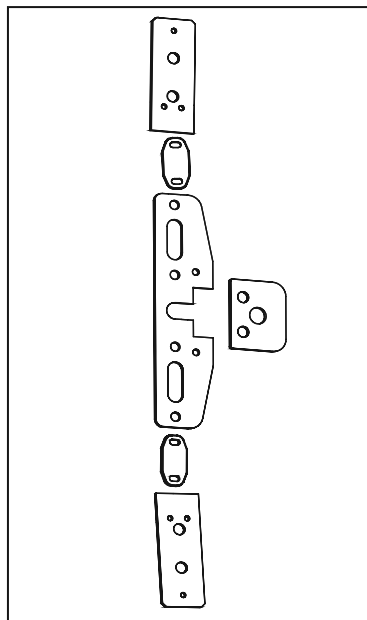

EXIT DEVICES

6000 Series Shim Kits

For technical support contact Yale® at
800.438.1951 x5033 or support@yalelocks.com

80-9460-6008-000 9/15

Yale®

Kit Numbers: 623SK, 623NS, 625AP for Rim, Mortise, and CVR Exit Devices:

Exploded View Showing Shim Placement (Covers Removed)

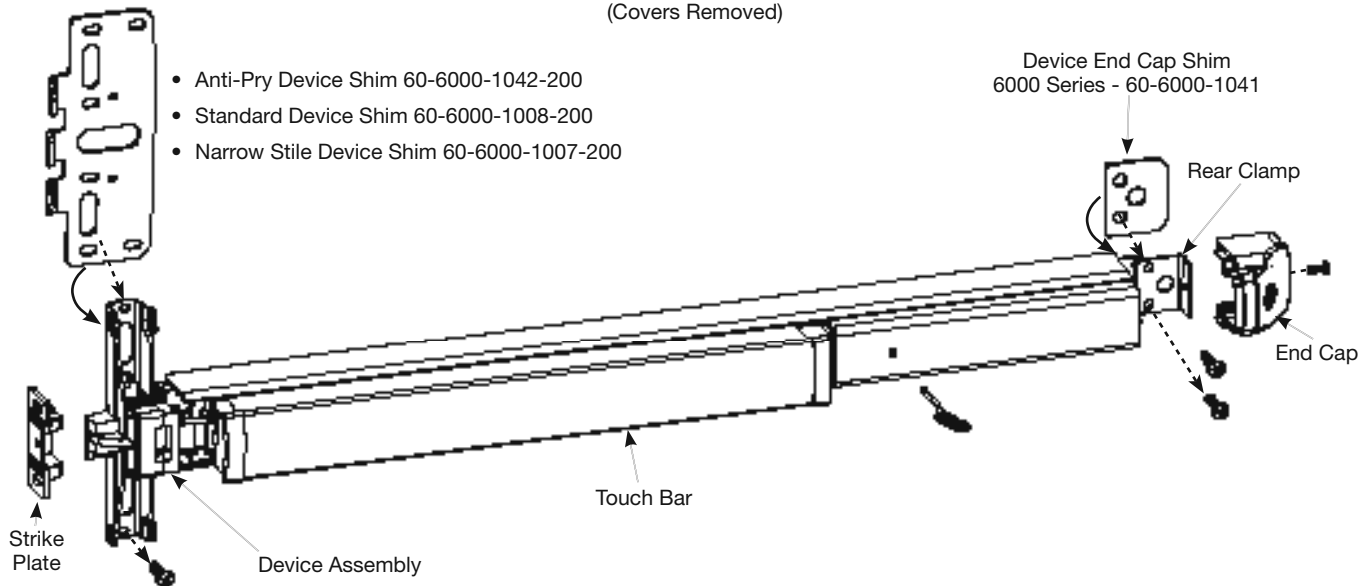

IMPORTANT:

The strike location on the frame may change when shim kit(s) are added. Verify, realign, measure and relocate the strike, if necessary, once the shims are installed.

Anti-Pry Shim Location on Device (Top View)

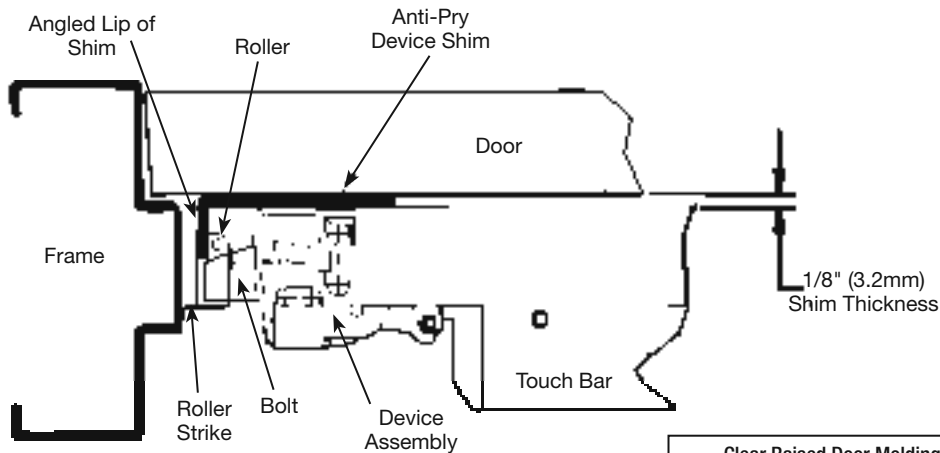
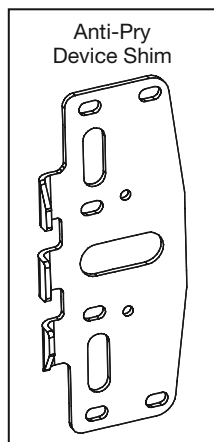

Clear Raised Door Molding
Use one (1) Shim for each
1/8" (3.2mm) of device lift needed

Continued



6000 Series Shim Kits

For technical support contact Yale® at
800.438.1951 x5033 or support@yalelocks.com

80-9460-6008-000 9/15



Shim Locations for Surface Vertical Rod Exit Devices

4. For Pullman and SquareBolt® devices, strike and shim locations will vary.
5. If installed correctly, the angled lip of the anti-pry shim will prevent access to the roller strike, located between the roller and bolt, as shown in the previous figure.

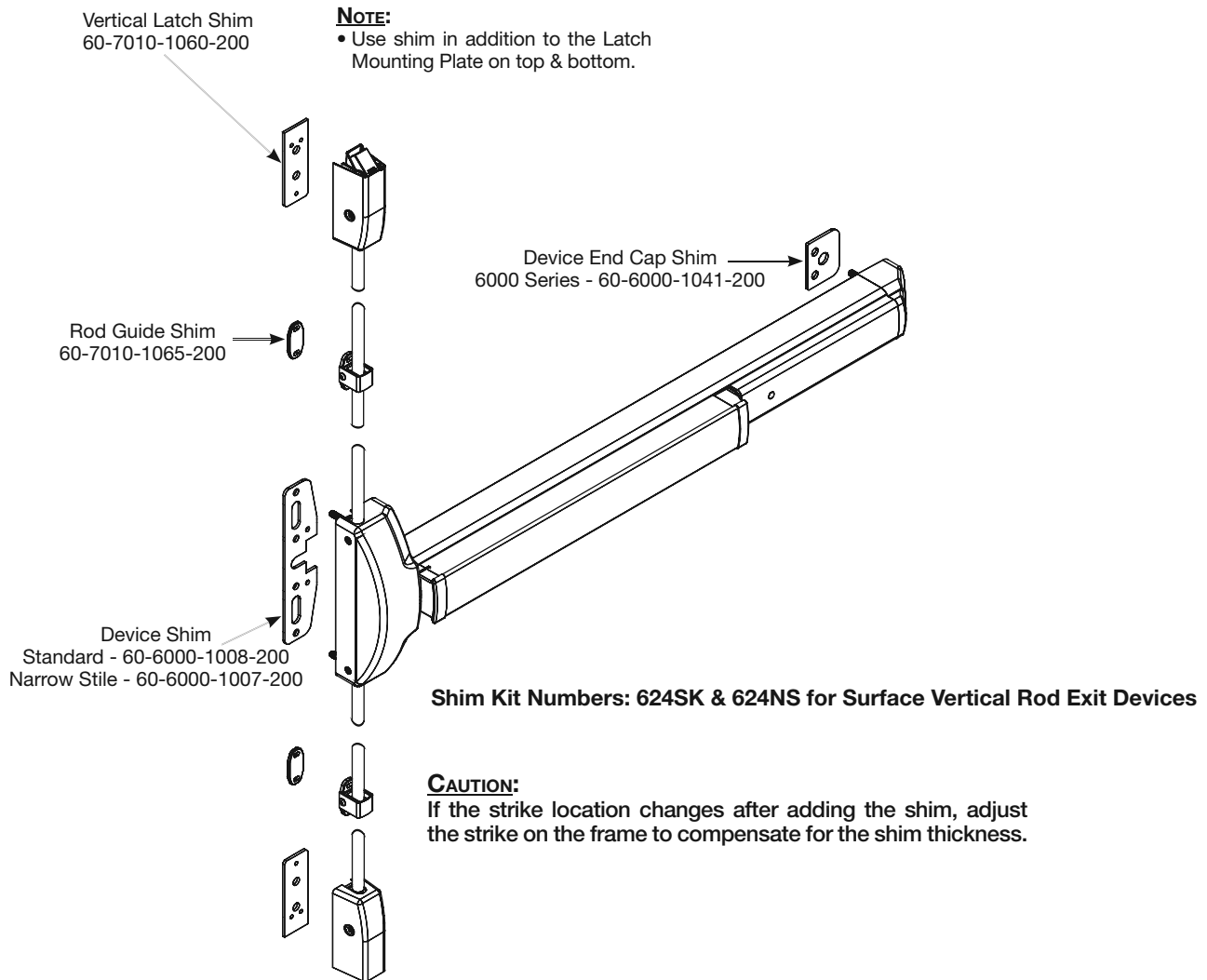

Continued



EXIT DEVICES

6000 Series Shim Kits

For technical support contact Yale® at
800.438.1951 x5033 or support@yalelocks.com

80-9460-6008-000 9/15



Standard Shim Location on Device
(Top View)

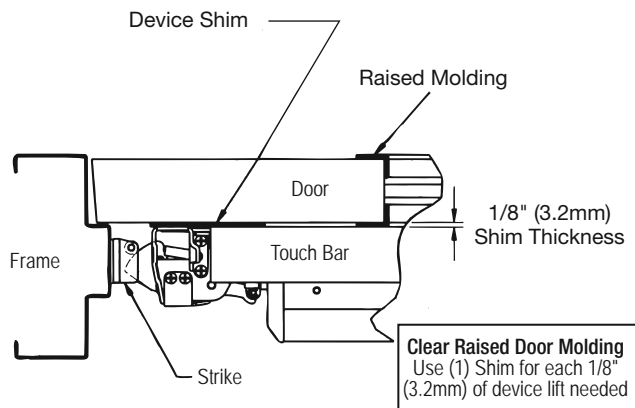

CAUTION:

If the strike location changes after adding the shim, adjust the strike on the frame to compensate for the shim thickness.

Yolk Pin Shim Location
For Concealed Vertical Rod Devices
(Side View)

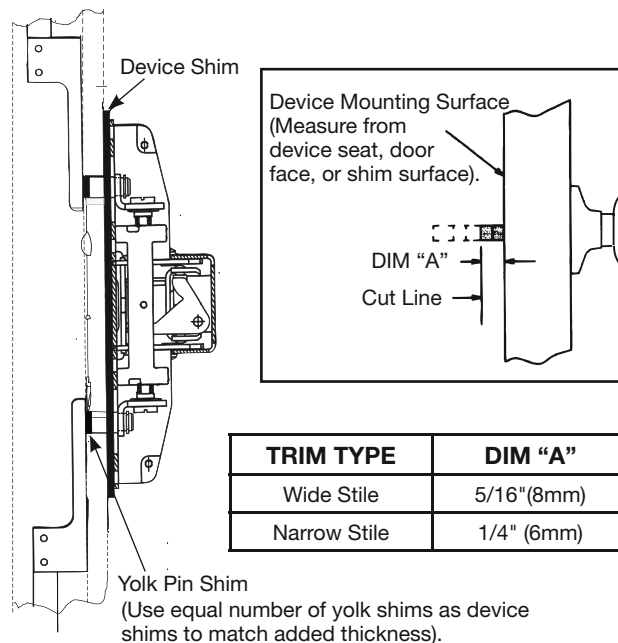

6. For Concealed Vertical Rod Exit Device, note yoke pin shim location.

7. After all shims and device installation, check proper function and operation of trim, key, touchbar and bolt engagement.

Yale Locks & Hardware

Product Support Tel 800.438.1951 • www.yalelocks.com

Yale Locks & Hardware is a division of Yale Security Inc., an ASSA ABLOY Group company.

Yale® is a registered trademark of Yale Security Inc., an ASSA ABLOY Group Company.

Other products' brand names may be trademarks or registered trademarks of their respective owners and are mentioned for reference purposes only.

These materials are protected under U.S. copyright laws.

All contents current at time of publication. Yale Security Inc. reserves the right to change availability of any item in this catalog, its design, construction, and/or its materials.

Copyright © 2015 Yale Security Inc., an ASSA ABLOY Group Company.

All rights reserved.

Reproduction in whole or in part without the express written permission of Yale Security Inc. is prohibited.